

Technaxx® * User Manual

TX-HR6 Fitness tracker with color display

The manufacturer Technaxx Deutschland GmbH & Co.KG hereby declares that this device, to which this user manual belongs, complies with the essential requirements of the standards referred to the Directive **RED 2014/53/EU**. The Declaration of Conformity you find here: www.technaxx.de/ (in bar at the bottom “Konformitätserklärung”). Before using the device the first time, read the user manual carefully.

Service phone No. for technical support: 01805 012643 (14 cent/minute from German fixed-line and 42 cent/minute from mobile networks). Free Email: support@technaxx.de

This device has a rechargeable battery. It must be fully charged before first use. NOTE: Charge the battery of the device every 2–3 month if it is not used!

Keep this user manual for future reference or product sharing carefully. Do the same with the original accessories for this product. In case of warranty, please contact the dealer or the store where you bought this product. **Warranty**

2 years

*Enjoy your product *Share your experience and opinion on one of the well-known internet portals.*

Features

- Fitness tracker to monitor your sport activities, heart rate, your fitness and your sleep activities
- Displays heart rate, steps, distances, burned calories, sleep time, weather, date and time
- Notification reminder: calls, SMS, WhatsApp, social media, achieved goals, activity reminder, drink reminder
- Free LeFun Health APP in Google Play Store and Apple AppStore
- Anti-lost function: find your mobile phone or the Fitness tracker
- IP67 Waterproof
- 20 days standby time
- Wake up screen by turning your wrist

Technical specifications

Display	0.96" (2.4cm) Colour Screen (80*160 Pixel)	
Processor	PHY6202	
Heart rate sensor	EM7128	
Protection class	IP67	
Bluetooth / Distance	Bluetooth Version 4.0 / ~10m	
BT transmitting frequency	2.4GHz	
BT max. radiated output power	5mW	
Power supply	Built-in rechargeable 90mAh Lithium-polymer battery 3,7V	
Operating time	~7 days usage / ~20 days standby	
Charging time	~1-2 hour	
APP	Lefun Health	
Supported APP Languages	GB, DE, FR, SP, PT, RU, FIN (September 2020)	
Weight / Dimensions	21g / (L) 52.7 x (W) 19.4 x (H) 13mm	
Wristband length	16 – 21 cm	
Storage temperature / Operation temperature	-25°C to 45°C	
Package Contents	Technaxx® Fitnesstracker TX-HR6, user manual	
Compatibility	Android 8.0or above & iOS 11.0 or above	

Charging

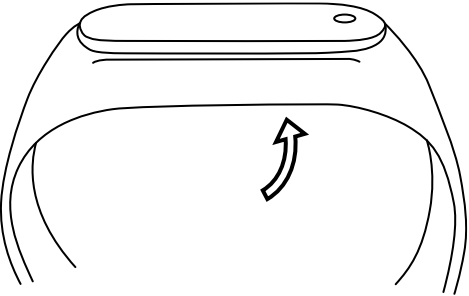
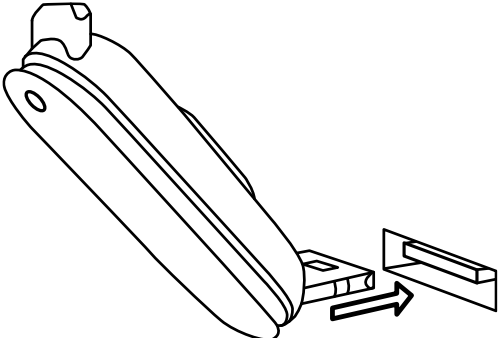
	<p>Hold the strap at the right side and push out the Fitnesstracker by pressing from the backside</p>
	<p>Now connect the fitnesstracker to a USB port to charge it</p> <p>Note: Pay attention to the contacts</p>

Product overview

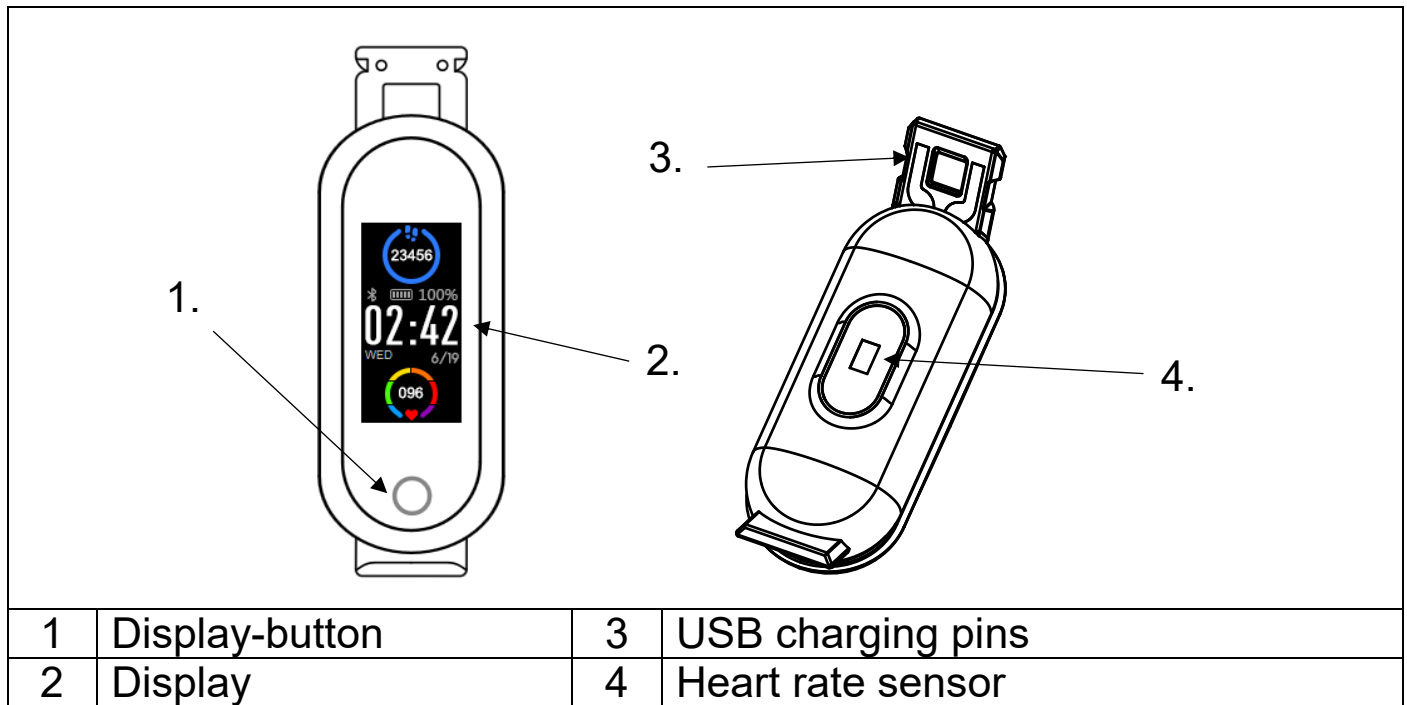

NOTE: The device should be charged at least 1 hour before use.

Start up

Hold the display button for 5 seconds.

Install LeFun Health APP on your Smartphone

Search for “LeFun Health” APP in the Google Play Store/Apple APP-Store or scan the following QR code for the installation.



App Icon



Google Play Store



Apple App Store

Connect the Fitnesstracker with the LeFun Health APP

Wait until the device is fully charged. Activate the Bluetooth of your Smartphone. Than open the APP. Confirm all requests to get the most out of the APP. Press „Search“ and choose “**TX-HR6**” from the list and you are ready. Now the Fitnesstracker is connected with your Smartphone and the APP.

Note: Under iOS you need to press pair in the popup to connect APP and TX-HR6.

INFO: If the last mobile device connected to your Fitnesstracker is turned on and the Bluetooth function is activated on both devices, then the Fitnesstracker will automatically connect with the mobile device.



Start using

When the Fitnesstracker is connected to the APP successfully, it will synchronize the time, the date and the language. It counts steps, distance and calories automatically. Press the display button to activate the LCD screen. Swipe with the display button through the menu. To start or enter an option hold the touch button.

Main screen

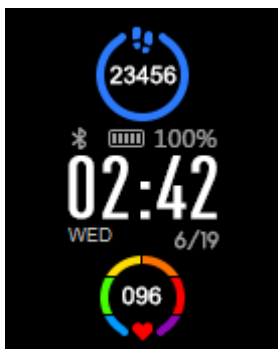

The main screen shows up common information like Date/Time/Heart rate/Steps/Battery Status

State (Steps, Distance, Calories)



State

Press the display button until you see this information. Hold the display button to see your current stats. The steps will be counted automatically. The distance will be calculated automatically. The burned calories will be calculated automatically. For more information about your steps please go to the APP.

Heart rate



BPM

Press the display button until you see this option. Hold the button to start this option. Your heart rate will be measured now.

Select a sport



Sport

Press the display button until you see this option. Hold the display button to enter this option. Now you can choose between different sports. Press until you have reached the desired sport. Now hold the button. The desired sport starts.

Music



Music

Press the display button until you see this option. Hold the display button to enter this option. Now you can choose between play/pause, next, previous and back. Press until you have reached the desired function. Now hold the display button to activate the function.

Message



Message

Press the display button until you see this information. Missed messages will be counted and displayed here.

Settings



More

Press the display button until you see this option. Hold the button to enter this option. “Find my phone”, see the system informations and reset are options. Power off is also available over this option.

Power-Off

Press the display button until you see “More”. The last option under “More” is power off. Hold the button to power off the device.

Hints

- Bluetooth connection becomes disconnected when the device exceeds a certain distance.
- Reconnect with Bluetooth if Bluetooth does not work for more than 5 min.
- Before binding the bracelet to another account, you need to unbind it with the current account.
- If the bracelet cannot be illuminated, connect the bracelet to the charger.

Safety instructions

- Rebuilding or modifying the product impairs product safety.
- All modifications and repairs of the device or accessories must be performed by the manufacturer or by persons expressly authorized by the manufacturer.
- Never open the product by yourself or perform repairs by yourself!
- Handle the product carefully. It can be damaged by knocks, blows or even by falling from low height.
- Keep the product away from damp, moisture and extreme heat.
- Never immerse the product in water or other fluids.
- Technical specifications are subject to change without notice.
- Never heat the battery above 60°C and do not drop or throw it into the fire, danger of explosion/fire hazard!
- Do not short-circuit the battery.
- Do not subject the battery to mechanical stress. Avoid dropping, striking, bending, twisting or cutting the battery.
- Discontinue the charging

process immediately should the battery become overheated. A battery that becomes overheated or deformed during the charging process is defective and should no longer be used. ● Never drain the battery completely, as this shortens its lifetime. ● If the battery must be stored, it is recommended that it be stored at 30% of its loading volume. Store out of direct sunlight. Ideal storage temperature: 10–20°C. ● Keep the product away from little children.

Disposal

Old electrical appliances from private households

● If you no longer want to use the appliance, hand it in free of charge at a public collection point for old electrical appliances. ● Old electrical appliances must never be placed in the residual waste bins.

Further disposal instructions

● Return the old electrical appliance in such a way that its subsequent reuse or recycling is not impaired. Batteries must be removed beforehand and the destruction of containers containing liquids must be avoided. ● Old electrical appliances can contain harmful substances. If the device is handled incorrectly or damaged, this can lead to damage to health or water and soil contamination when the device is later recycled.

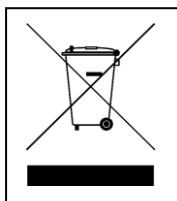

Hints for Environment Protection: Packages materials are raw materials and can be recycled. Do not disposal old devices or batteries into the domestic waste. **Cleaning:** Protect the device from contamination and pollution. Avoid using rough, coarse-grained materials or solvents/aggressive cleaner. Wipe the cleaned device accurately. **Distributor:** Technaxx Deutschland GmbH & Co.KG, Kruppstr. 105, 60388 Frankfurt a.M., Germany