

# Technaxx<sup>®</sup> \* User Manual

## FM DAB Transmitter FMT1500BT

The manufacturer Technaxx Deutschland GmbH & Co.KG hereby declares that this device, to which this user manual belongs, complies with the essential requirements of the standards referred to the Directive

**RED 2014/53/EU**. The Declaration of Conformity you find here:

**[www.technaxx.de/](http://www.technaxx.de/)** (in bar at the bottom "Konformitätserklärung").

Before using the device the first time, read the user manual carefully.

Service phone No. for technical support: 01805 012643 (14 cent/minute from German fixed-line and 42 cent/minute from mobile networks).

Free Email: **[support@technaxx.de](mailto:support@technaxx.de)**

Keep this user manual for future reference or product sharing carefully.

Do the same with the original accessories for this product. In case of warranty, please contact the dealer or the store where you bought this product.

**Warranty 2 years**

***Enjoy your product. \*Share your experience and opinion on one of the well-known internet portals.***

## Features

- FM & DAB Radio transmitter
- With external DAB antenna for best signal receiving
- Bluetooth transmission
- SD-Card slot
- 2 USB charger (Quick charge 3.0 & 2.4A)
- Line in (AUX)
- Microphone for calls

## Product details

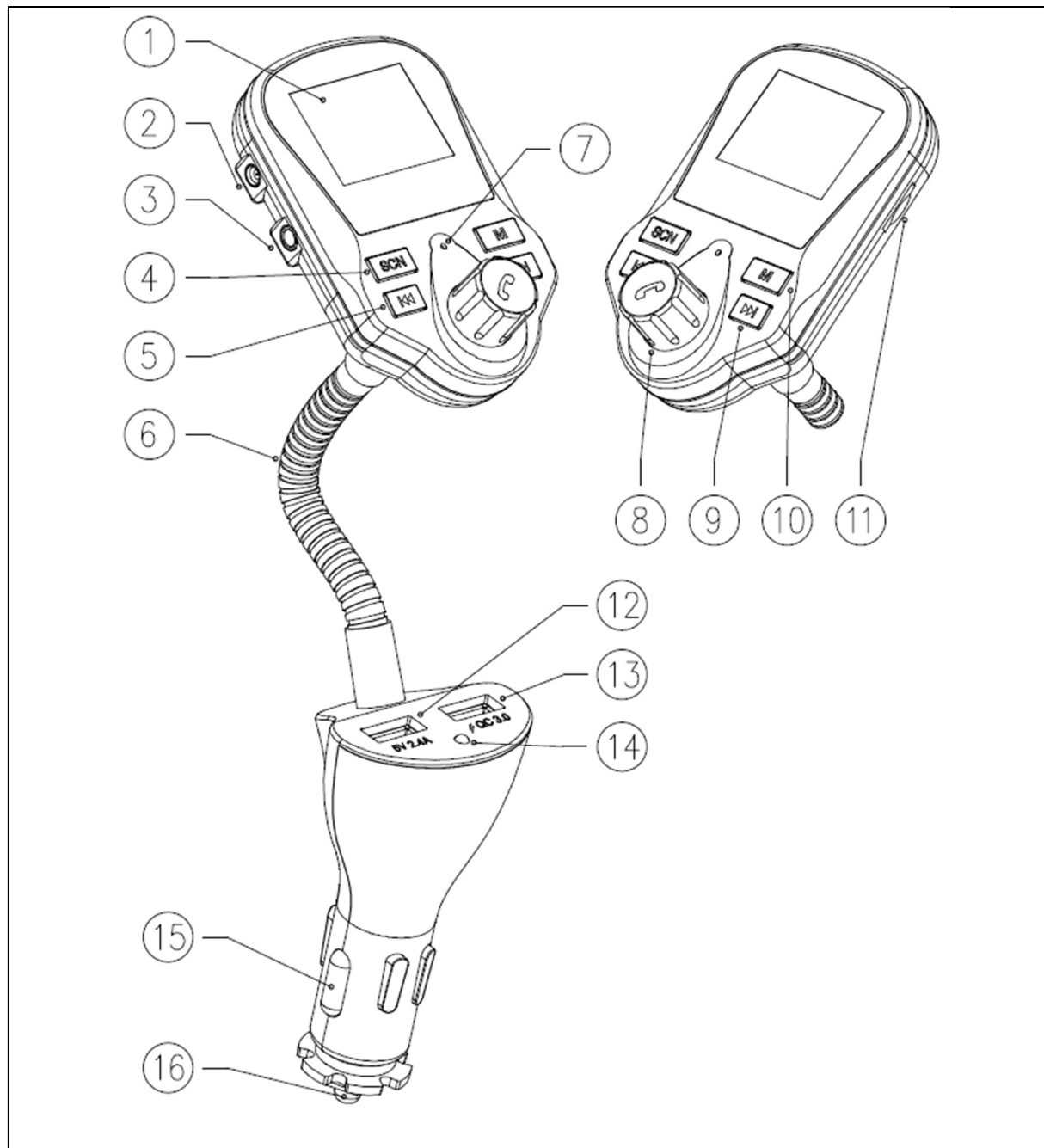

1	LCD Display	9	Next track
2	DAB antenna connection	10	Mode button
3	AUX-port	11	SD-Card slot
4	SCN-button	12	DC 5V/2.4A charging port
5	Last track	13	QC3.0 charging port
6	Flexible hose	14	Charging indicator LED
7	Microphone	15	Car charger negative shrapnel
8	Rotary switch	16	Car charger positive shrapnel

## Button features

SCN button	Short press this button in on state to enter FM- transmission frequency setting. Increase or decrease FM transmission frequency by rotate switch button. In DAB mode, long press this button for auto scan channel frequency.
Last track	When playing music, short press to go to last track.
Rotary switch	While playing music, rotate clockwise to increase sound, rotate anticlockwise to decrease sound. Short press for play and pause. While phone calls, short press this button to receive or end phone calls.
Next track	When playing music, short press to go to next track
Mode button	Short press this button to change the mode. Modes are: DAB-BT-TF-AUX. Under DAB mode, long press to enter menu option to change backlight, contrast, language setting.

## Installation of the DAB-Antenna

Insert the DAB antenna connection plug to the FM-DAB-Transmitter antenna connector.

Attach the antenna to a spot at a window to receive the best signal.

**NOTE:** Please do not attach it in the sight field of the driver.



## Modes

To change the mode please press “M” button on the device.

## **FM Transmitter**

Insert the FMT1500BT into the cigarette lighter on the car. The car charger power light will light up, indicating that the power supply has been turned on. Short press “SCN” button and “switch rotary” button to adjust the transmitting frequency to match car FM frequency. Can also adjust car FM frequency to match with this FM transmitter’s frequency.

## **DAB mode**

Power on, put the DAB receiving antenna (comes with transmitter) to the DAB antenna connector, short press “M” button to change to DAB mode; Long press “SCN” button for DAB station automatically searching. After finished searching, short press “◀◀” to last station; short press “▶▶” to next station; short press “Rotary switch” to confirm the current station to play.

## **Bluetooth mode**

**Under DAB mode, short press “M” button to change to Bluetooth mode.** It starts searching previous paired Bluetooth device. If it fails to connect, it begins pairing other Bluetooth devices. In this case, turn on your Bluetooth device to search. PIN code is “0000”. Music streams after pairing successfully. Short press rotary switch to play or pause. Short press “◀◀” to last track; short press “▶▶” to next track. When phone calling, short press rotary switch to receive or end phone calls.

## **SD card mode**

Under Bluetooth mode, short press “M” to change to TF card mode. Plug SD card to play music. Short press “Rotary switch” to play or pause. Short press “◀◀” to last track; short press “▶▶” to next track.

## **AUX Mode**

Under SD mode, short press “M” to change to AUX mode. Plug one end of audio cable into AUX port of transmitter and the other end into the audio port of Mobile Phone, Notebook, Tablet PC, MP3-player etc. After that, you’ll be able to enjoy music through this FM transmitter to the car speakers. Short press “rotary switch” to mute or replay music.

## Settings

Please press “M” button long to enter menu options to change the settings of backlight and contrast, see system information and reset to factory settings. Use the rotary switch to change the settings and press the switch to accept the changes. Short press “M” button again to go back.

## Technical specifications

Input voltage	DC 12~24V
Bluetooth version	V4.2
Bluetooth distance	≤10m
Bluetooth frequency / power	Frequency band 2.4GHz Radiated transmission power max. 2.5mW
Input current	<100MA
AUX	3.5MM-AUX
USB1	≤5V/2.4A
USB2	QC3.0
Supported audio format	MP3\WMA
MicroSD card capacity	128MB~32GB
FM frequency range	87.5--108.0MHZ
FM transmission distance	< 5 m
Frequency response	20Hz-15KHz
Distortion	< 0.1%
SNR	> 60dB
Operating temperature	0 up to 60°C
Package content	Technaxx FMT1500BT, DAB antenna, line-in cable, user manual

## Troubleshooting

- Please make sure that voltage of car cigarette lighter is 12-24V, otherwise, the product work abnormally or even gets destroyed.
- While choosing channels, please avoid strong signal channel to in case of affecting sound quality.
- If car audio fails to receive music, please check if the frequency of transmitter and car is the same, or volume up to increase output.
- Use car audio to adjust volume. Don't increase too much volume, or distortion occurs. Should distortion happen, volume down to resume.
- If the Bluetooth device fails to link to the FM-Transmitter or if it fails to play music after being connected, the user shall check if the correct PIN code is entered or if the Bluetooth device supports A2DP.
- For safety reason, please pull out car charger while not using.

## Warnings

- Do not remove any cover to avoid the risk of an electric shock or other damages.
- Do not attempt to disassemble the device, it may result in short-circuit or even damage.
- Do not drop or shake the device, it may break internal circuit boards or mechanics.
- Keep the device in dry and ventilated environment.
- Avoid high humidity and high temperature.
- Do not expose this device to rain or moisture to reduce the risk of fire or electrical shock. The device should not be exposed to dripping or splashing.
- Keep the device away from little children.

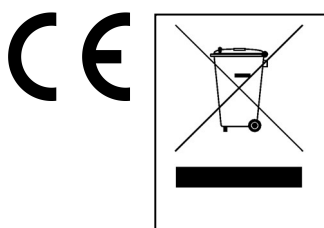

**Hints for Environment Protection:** Packages materials are raw materials and can be recycled. Do not disposal old devices or batteries into the domestic waste. **Cleaning:** Protect the device from contamination and pollution. Avoid using rough, coarse-grained materials or solvents/aggressive cleaner. Wipe the cleaned device accurately. **Distributor:** Technaxx Deutschland GmbH & Co.KG, Kruppstr. 105, 60388 Frankfurt a.M., Germany