

Radiator Fan - Mono Set TX-302

Radiator Fan - Extension TX-303

Before using the appliance for the first time, please read the instructions for use and safety information carefully.

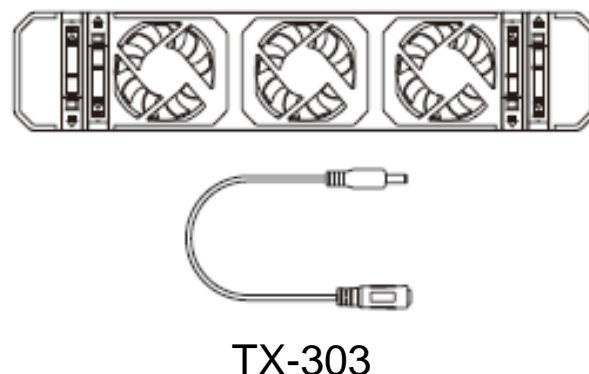
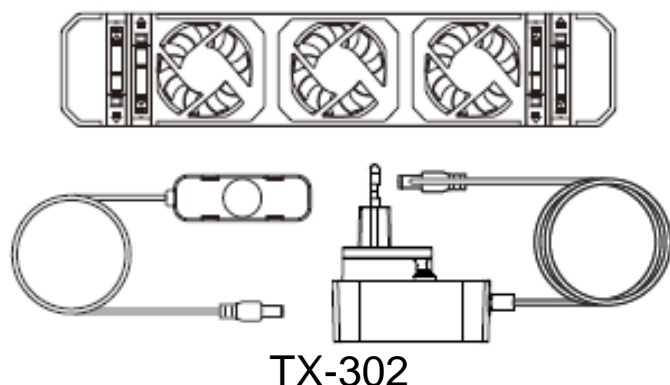

This appliance is not intended for use by persons (including children) with reduced physical, sensory or mental capacities, or by persons lacking in experience or knowledge, unless they are supervised or instructed on the use of this device by a person responsible for their safety. Children should be supervised to ensure they do not play with this device.

Keep this user manual for future reference or product sharing carefully. Do the same with the original accessories for this product. In case of warranty, please contact the dealer or the store where you bought this product.

Enjoy your product. * Share your experience and opinion on one of the well-known internet portals.

Specifications are subject to change without notice - please be sure to use the latest manual available on the manufacturer's website.

Table of Contents

Hints	2	Single plate radiator	10
Safety instructions	2	Convector	10
Warnings	3	Optimize the Central Heating ...	12
Disclaimer.....	3	Distribute the MainUnits	12
Features	4	Lower the temperature setpoint	12
System Overview	4	Hydronic balancing	12
Package content.....	4	Maintenance	13
Product overview.....	5	How to Maintain the MainUnit. 13	
Installation	6	Cleaning the product	13
Determine the type of your radiator	6	Troubleshooting.....	13
Connect the MainUnit to the Radiator	7	Technical Specifications.....	15
Wide radiator (plates \geq 70 mm apart)	7	Support.....	15
Narrow radiator (plates $<$ 70 mm apart)	9	Care and maintenance	15
		Declaration of Conformity.....	15
		Disposal.....	16

Hints

● Only use the product for purposes due to its intended function ● Do not damage the product. Following cases may damage the product: Incorrect voltage, accidents (including liquid or moisture), misuse or abuse of the product, faulty or improper installation, mains supply problems including power spikes or lightning damage, infestation by insects, tampering or modification of the product by persons other than authorized service personnel, exposure to abnormally corrosive materials, insertion of foreign objects into the unit, used with accessories not preapproved. ● Refer to and heed all warnings and precautions in the user manual.

Safety instructions

- The product is intended to distribute the air from the radiator for better circulation and faster heating. It is intended for use by private individuals.
- Use this product only as a radiator ventilator by attaching it to a radiator. Follow the instructions in this manual to do so.
- Never touch the product with wet or damp hands.
- The product can only be operated with the voltage described on the interior panel.
- Do not place the product on an unstable surface. The unit could be damaged or persons could be injured. Any attachments should be made

only in accordance with the manufacturer's instructions or obtained from the manufacturer.

- The cable is sheathed and insulates the current. Do not place any objects on the cable, as this could cause the protective function to be lost. Avoid placing excessive stress on the cable, especially at sockets and plugs.
- If you want to pull the plug out of the socket, always pull on the plug and not on the cable. The cable could otherwise break.
- Do not overload wall outlets, extension cords, or other wiring as this may result in fire or electric shock.
- Do not insert any objects into the openings of the unit, as current flows in some places and contact may cause fire or electric shock.
- Unplug the power cord from the power outlet for cleaning.
- Do not use liquid cleaners or cleaning sprays. The product may only be cleaned with a damp cloth.
- Do not connect any additional devices that are not recommended by the manufacturer.
- Keep the product away from open fire, soldering irons, or other hot tools as this could damage the product.
- Connect the product to a properly installed and easily accessible wall socket. Make sure the product can be disconnected from the power supply at any time.
- Never use the product outdoors. The product is intended for indoor use only.

Warnings

- Do not disassemble the product, it may result in short-circuit or damage.
- Do not modify, repair or remove without professional guidance.
- Do not use corrosive or volatile liquid for cleaning.
- Do not drop or shake the device, it may break internal circuit boards or mechanics.
- Keep the device away from little children.

Disclaimer

- In no event shall Technaxx Deutschland be liable for any direct, indirect punitive, incidental, special consequential danger, to property or life, improper storage, whatsoever arising out of or connected with the use or misuse of their products.

Features

TX-302 Mono Set

- Allows you to lower the temperature of your heating system and save energy and money.
- Heats up your rooms very quickly.
- Very low power consumption.
- Easy to install and fits most steel hot water radiators and convectors.
- Automatic on/off thanks to the included temperature sensor.
- Super quiet while optimizing the air flow.

TX-303 Extension

- Once installed, the extension set works together with the Mono Set. Suitable for extending an existing Technaxx Mono Set.
- PLEASE NOTE! This product is only suitable for extending an existing Technaxx Mono Set and cannot be used separately. This extension set does not include an adapter or a temperature sensor.

System Overview

This product has three parts that work together.

The MainUnit is the main component. The MainUnit is connected to a power adapter and a temperature sensor.

- For a wide radiator (70 mm or more apart), this is all you need.
- For other radiators, just move the magnetic sliders or feet.
- For a narrow radiator (plates less than 70 mm apart), place the magnetic sliders with the magnet facing up, two on each side.
- For a single plate radiator, put the sliders on one side with the magnet up.
- For a convector, put the four feet in the holes on the bottom of the MainUnit.

Connect additional MainUnits with the 30 cm extension cable.

Package content

TX-302 - Mono Set	TX-303 - Extension
1x MainUnit 1x Temperature sensor 1x Power adapter 1x User Manual	1x MainUnit 1x Extension cable (30cm) 1x User Manual

Product overview

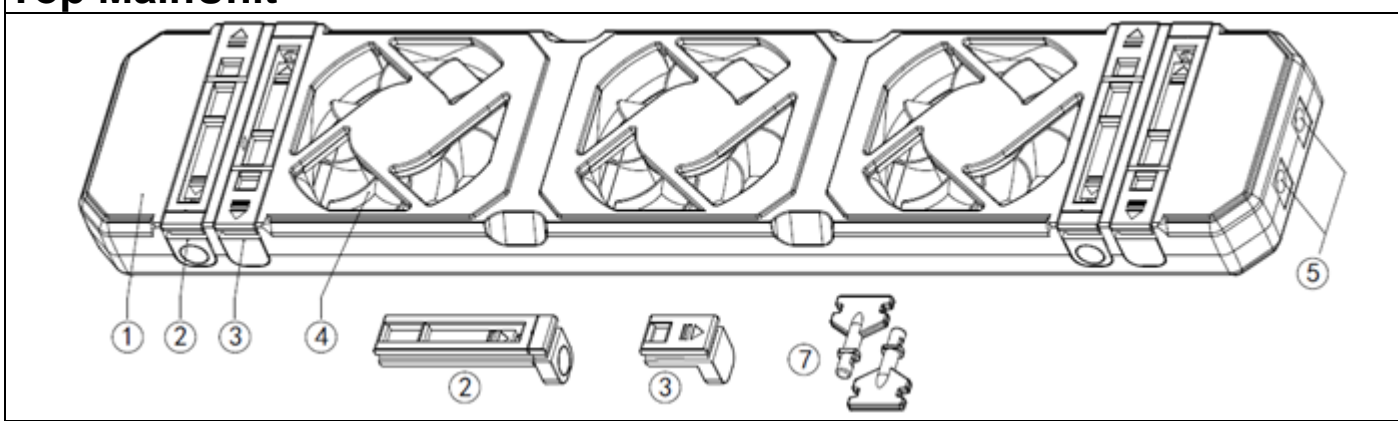
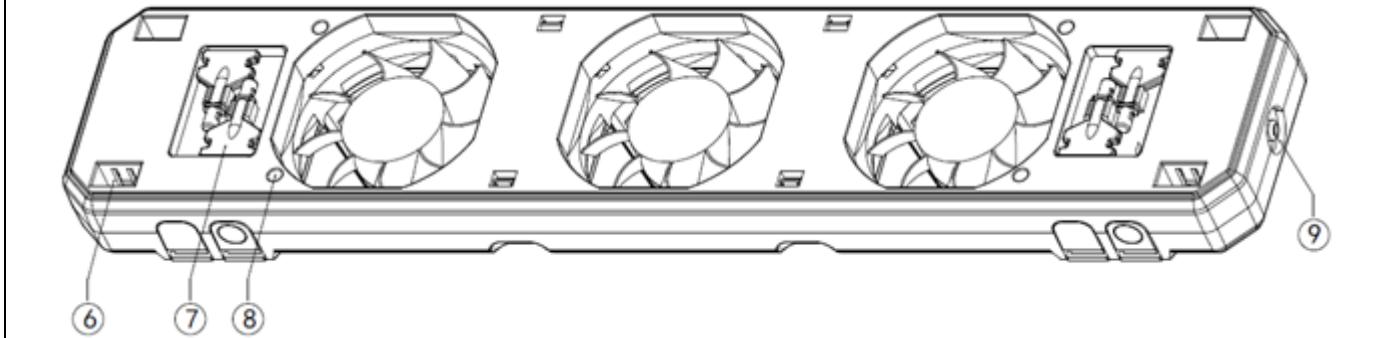
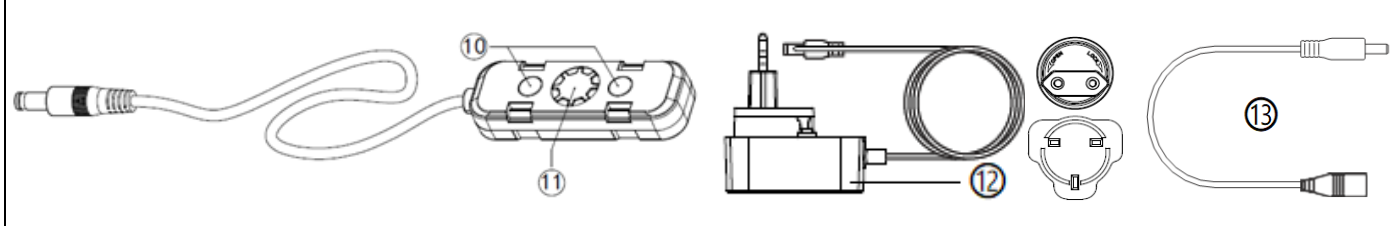
Top MainUnit					
					
Bottom MainUnit					
					
Accessory					
					
1	MainUnit	6	Adjustable magnet holder socket	11	Temperature sensor
2	Adjustable magnet holder (4x)	7	Support pin (4x)	12	Power adapter (EU & UK)
3	Fake block (4x)	8	Support pin socket	13	Extension cable (30cm)
4	Fan	9	DC male socket (connection to next MainUnit)		
5	DC power input & Temp. sensor input	10	Magnet holder		

Installation

Determine the type of your radiator

The MainUnit can be installed on different types of radiators. Each type of radiator has a different installation method.

Determine your radiator type:

1. Decide which radiators you want to install the MainUnit on.

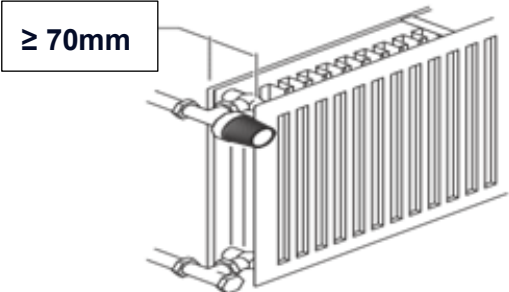
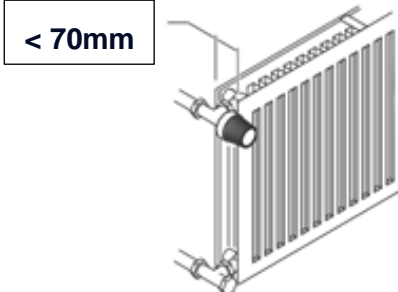
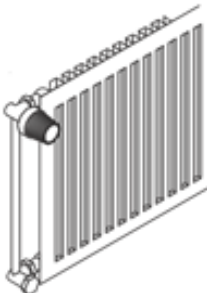
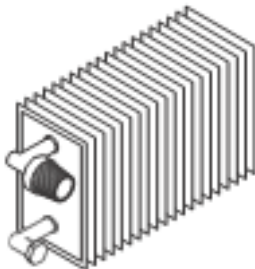
 <p>≥ 70mm</p>	 <p>< 70mm</p>
A wide radiator has a distance of 70 mm or more between the plates.	A narrow radiator has a distance between the plates of less than 70 mm.
	
A single-plate radiator has one plate.	Convectors are radiators with fins that circulate hot water. It is usually installed inside a convector.

Connect the MainUnit to the Radiator

The MainUnit can be installed on different types of radiators. Each type of radiator has a different installation method. Install this type of radiator according to the instructions.

Wide radiator (plates ≥ 70 mm apart)

1. Place the MainUnit upright and make sure the plugs face in direction of the power socket.

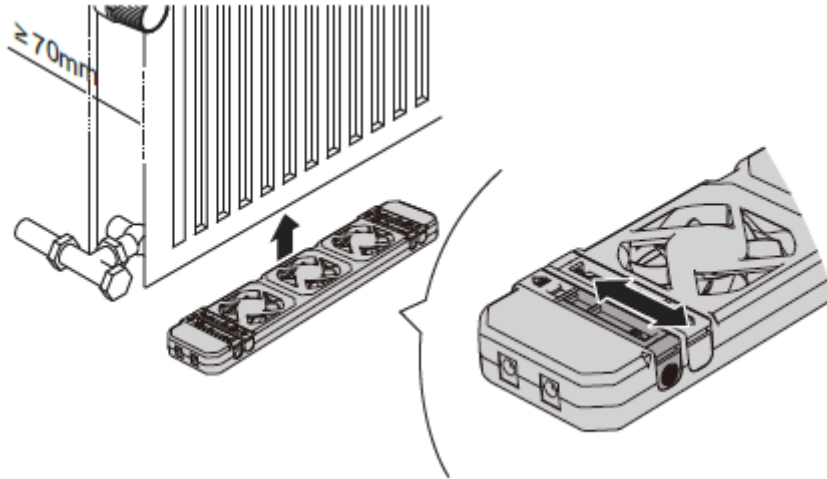

2. Find a place to put the radiator wall brackets and clips. Attach the MainUnit between the radiator plates with the magnets. You can also attach the MainUnit on top of the radiator and under a cover.

NOTE: Fans still face up!

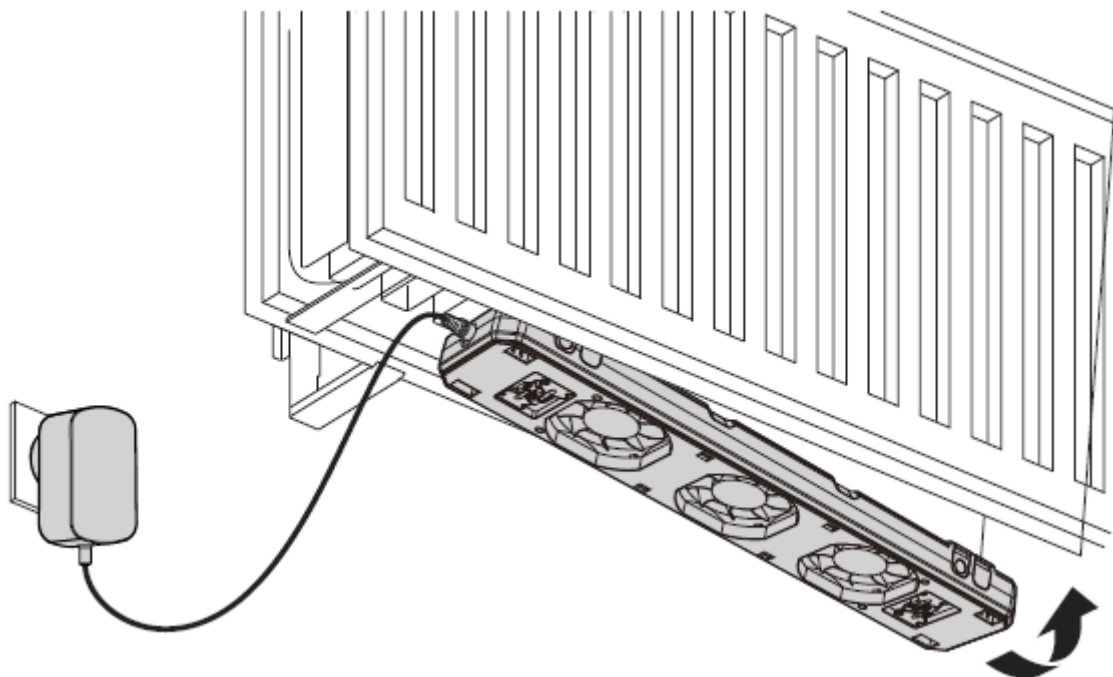

3. Connect the sensor cable to a female connector on the MainUnit.

4. Attach the temperature sensor to the back of the radiator or pipe. Adjust the sliders to the right width.

5. Connect the power adapter to the other female connector and the wall socket.

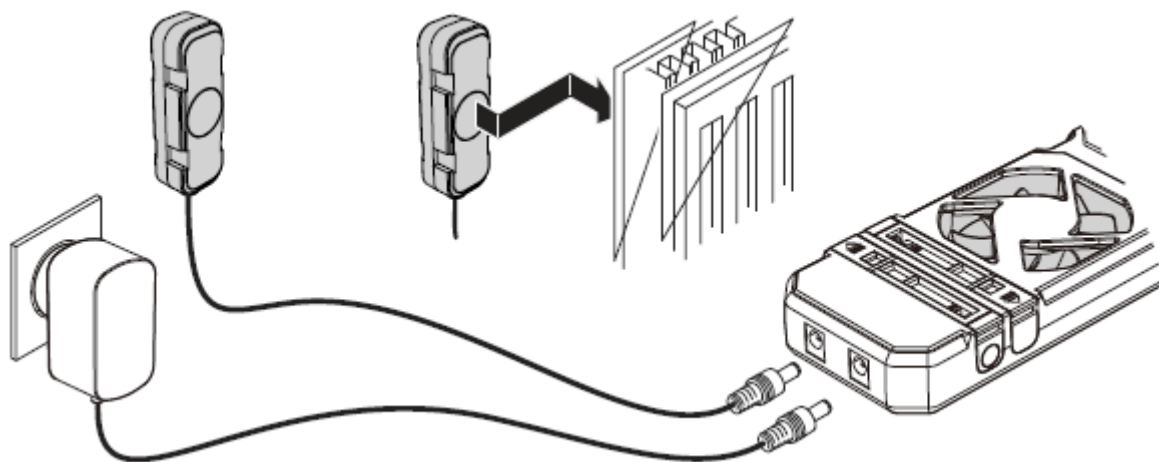

6. Connect additional MainUnits to long radiators with 30 cm cables. You can connect up to three MainUnits to one power adapter. No extra temperature sensors needed. The TX-303 Extension includes one MainUnit and one 30cm cable.

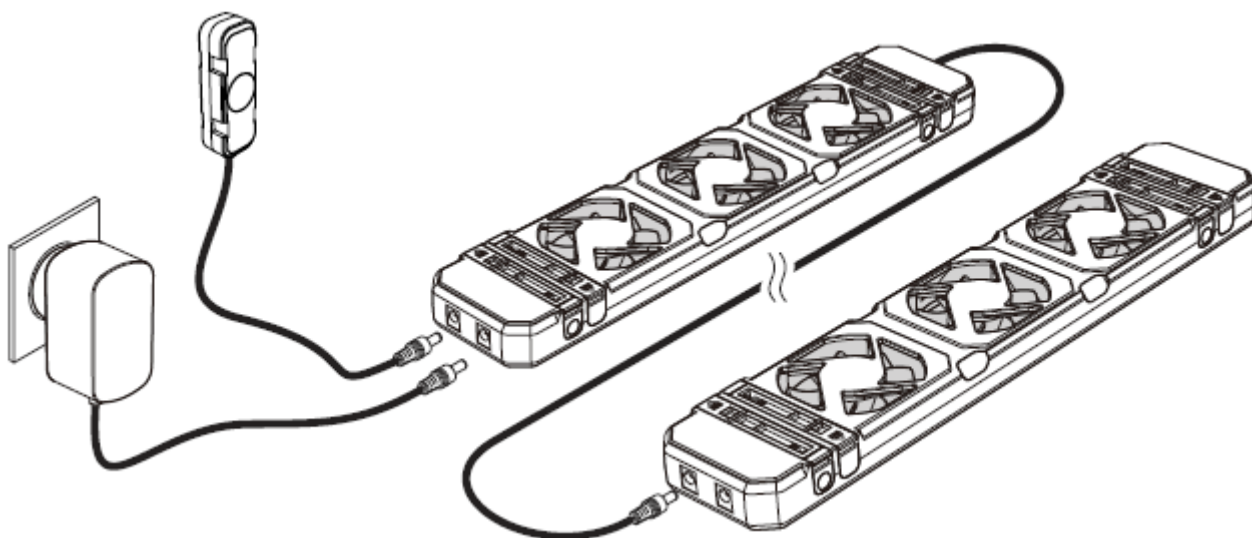

7. Turn on your heating. Wait for the MainUnit to turn on. This happens when the radiator is over 35°C. It switches off when the radiator cools to 25°C.

Narrow radiator (plates < 70 mm apart)

1. Turn the magnets until the magnet is on top. Remove the small block in the housing.
2. Adjust the magnets to the right width.

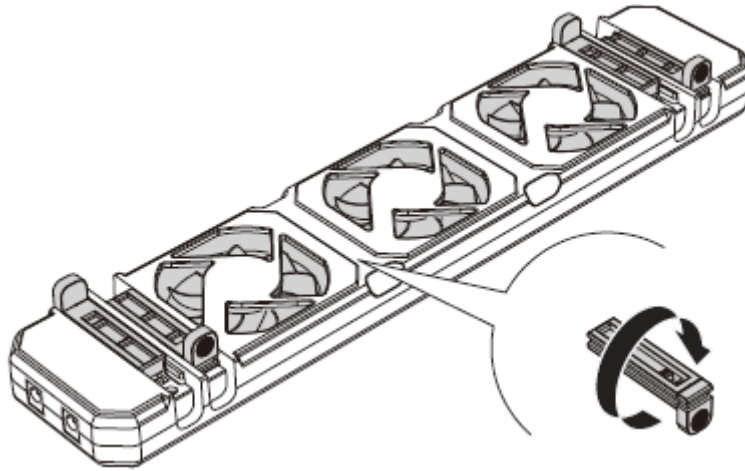

3. Repeat steps 1–7 for the wide radiator. Hang the MainUnit between the plates with adjustable magnets. Align the MainUnit with the front of the radiator.

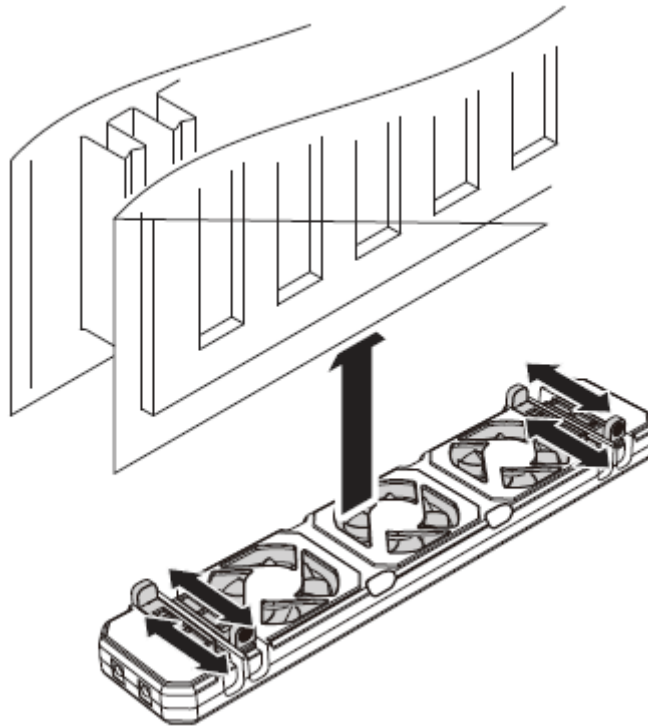

Single plate radiator

1. Place the magnets on the same side, facing up. Remove the small block opposite the adjustable magnets.
2. Repeat steps 1-7 for the wide radiator.
3. Attach the MainUnit to the single plate radiator with the adjustable magnets.

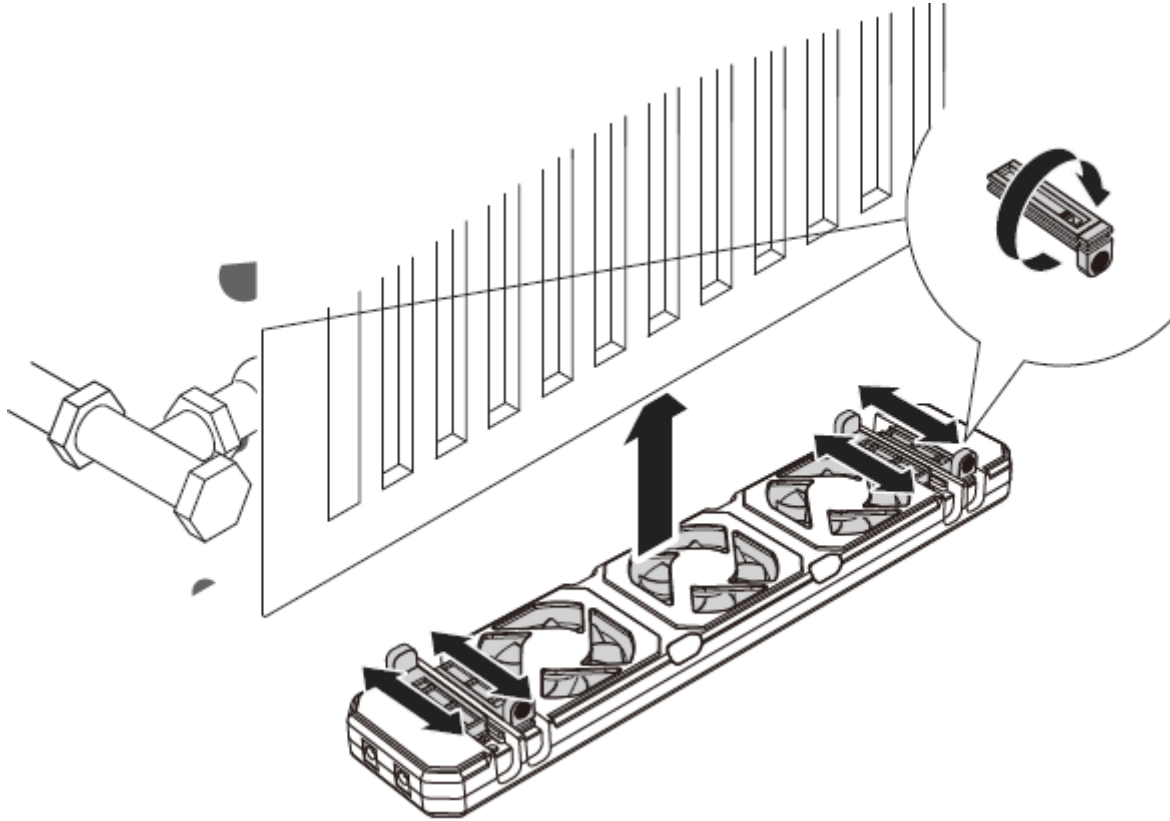

Convactor

1. Attach the feet by pushing them into the slots.
2. Make sure the MainUnit is facing up and the female connectors are pointing towards the wall socket.
3. Place the MainUnit on top of the convactor with some space between them to reduce noise. You can also put the MainUnit on the floor below the convactor if there's enough space.
4. If the block is magnetic, the sensor can be placed on it with magnets. Clamp the temperature sensor between two plates of the convactor block for better heat transfer.

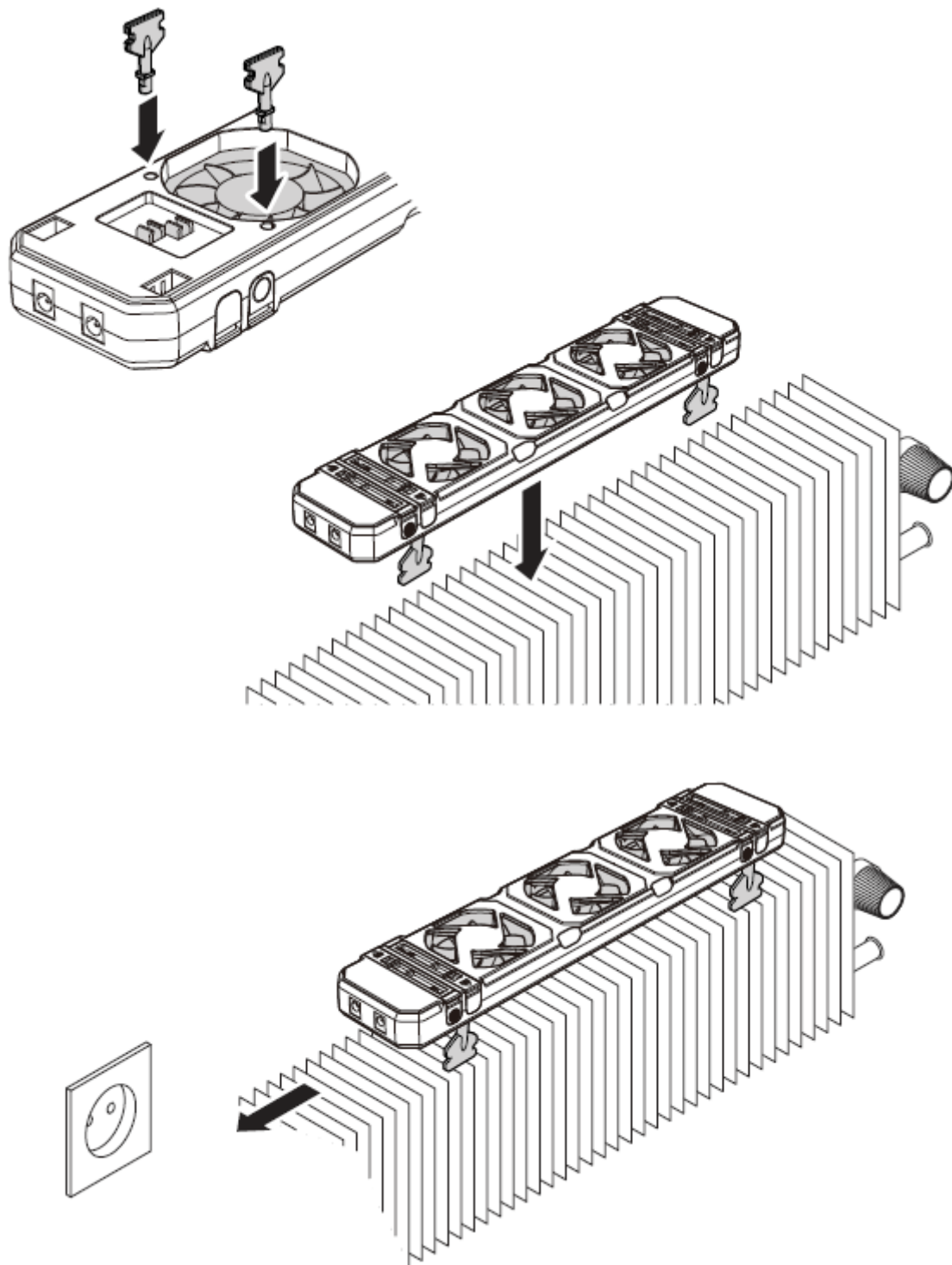

Optimize the Central Heating

The MainUnit heats the room from the radiator. This can save energy in your house. To save energy, a few things need to be optimized. The MainUnits must be placed throughout the house, the central heating temperature must be lowered, and the central heating system must be balanced.

Distribute the MainUnits

1. Install up to 3 units in an average living room.
2. Install in all regularly used rooms.

This ensures that all the air in the room circulates once per hour (since one MainUnit circulates 35 m³/h).

Lower the temperature setpoint

1. Lower the central heating temperature to at least 60°C. Check your central heating manual or ask your technician. You can make small changes to find the best setting. A lower setpoint saves energy.
2. Don't let your technician change this back to factory settings (75 - 90°C). The MainUnit heats the room by drawing heat from the radiator. This saves energy by allowing the boiler to shut down sooner.

Hydronic balancing

Balance the central heating system using the radiator screw, thermostat, or separate radiator valve. **CAUTION!**

Ask a central heating technician to help with balancing the central heating system. This is not a standard procedure.

Hydronic balancing distributes water in a heating system more efficiently. This helps the system use energy efficiently and keep room temperatures consistent.

Maintenance

How to Maintain the MainUnit

Cleaning the product

The MainUnit and matching components can be cleaned.

To clean the product:

1. Vacuum when dirty. CAUTION! Use the lowest power setting on the vacuum.
2. Wipe with damp cloth if needed. CAUTION! Keep water out of the MainUnit through the fans.

If any parts break, replace them. CAUTION! Do not open, modify, or repair the product.

Troubleshooting

Problem	Cause	Solution
MainUnit won't fit between radiator plates.	It is a narrow radiator.	Install the MainUnit like mentioned under narrow radiator.
The MainUnit won't fit at the bottom of the radiator.	There's not enough space.	Put the MainUnit on the radiator. This won't affect performance. The bottom is better because it's less visible. Make sure the MainUnit is upright.
The MainUnit needs to be attached at the top of the radiator, but there is a cover.	N/A	Put the MainUnit under the cover. This may shorten the MainUnit's lifespan.
The sensor can't reach the pipe.	The temperature sensor cable is too short.	You can also attach the temperature sensor to the back of the radiator.
The MainUnit won't fit between the wall and the radiator.	The space is usually less than 70 mm.	Install the MainUnit like mentioned under single plate radiator. If there's not enough space, attach the feet to the MainUnit and put the product on the floor below the radiator.

The MainUnit didn't turn on after it was plugged in.	The sensor isn't registering 35°C or more, or the MainUnit isn't getting power.	<ul style="list-style-type: none"> • Make sure the radiator is at least 35 degrees. • Attach the temperature sensor to the warm water supply pipe or close by. • Make sure the sensor makes proper contact. • If the radiator does not heat up, vent the central heating system. • Make sure the wall socket works and the power adapter is inserted.
The MainUnit doesn't increase radiator heat.	The MainUnit may be upside down. This makes the air flow the wrong way.	Turn the MainUnit over. The top has four white protective strips over the fans.
Old cast iron or single plate radiator, 55 mm from wall.	None of the four mentioned radiator types.	Attach the feet to the MainUnit and place on the floor under the radiator.
The MainUnit is too loud on the convector.	It's probably contact noise.	Don't let the MainUnit touch metal. Attach the feet.
The MainUnit doesn't turn off when the radiator is off/cold.	The sensor isn't turning it off.	Connect the MainUnit properly to the temperature sensor.

Technical Specifications

Power consumption	≤ 1W
External charger	In: AC100-240V~50/60Hz; 0.4A Max Out: DC5V/2A
Airflow	24-25cfm / 34-35m³/h
Fan speed	1800rpm
Noise level	< 20 dB
Temperature sensor	On: 35°C ; Off: 25°C
Working temperature	-20 - 85°C; RH Less than 80% (No condensation)
Storage temperature	-40°C - +85°C
Weight	0.32kg
Dimension (LxWxH)	34.5 x 7.0 x 2.5cm
Material	ABS + PC
Package contents TX-302	1x MainUnit, 1x Temperature sensor, 1x Power adapter (EU&UK), 1x User Manual
Package contents TX-303	1x MainUnit, 1x Extension cable (30cm), 1x User Manual

Support

Service phone No. for technical support: **01805 012643** (14 cent/minute from German fixed-line and 42 cent/minute from mobile networks). Free Email: **support@technaxx.de**

The support hotline is available Mon-Fri from 9am to 1pm & 2pm to 5pm

Care and maintenance

Clean the device only with a dry or slightly damp, lint-free cloth.

Do not use abrasive cleaners to clean the device.

This device is a high-precision optical instrument, so in order to avoid damage, please avoid the following practice:

- Use the device in ultra-high or ultra-low temperature.
- Deliver or use it in strongly shocking environment.

Declaration of Conformity



The EU Declaration of Conformity can be requested at the following address: www.technaxx.de/ (in the lower bar "Declaration of Conformity").

Disposal



Disposal of the packaging. Sort packaging materials by type upon disposal.

Dispose of cardboard and paperboard in the waste paper. Foils should be submitted for recyclables collection.



Disposing of old equipment (Applies in the European Union and other European countries with separate collection (collection of recyclable materials) Old equipment must not be disposed of with household waste! Every consumer is required by law to dispose of old devices that can no longer be used separately from household waste, e.g. at a collection point in his or her municipality or district. This ensures that the old devices are properly recycled and that negative effects on the environment are avoided. For this reason, electrical devices are marked with the symbol shown here.

Made in China

Distributed by:

Technaxx Deutschland GmbH & Co. KG
Konrad-Zuse-Ring 16-18,
61137 Schöneck, Germany

Radiator Fan - Mono Set TX-302
Radiator Fan - Extension TX-303