

Lifenaxx® * User Manual

Cordless Mite Vacuum Cleaner LX-068

with UV-C light

Before using the appliance for the first time, please read the instructions for use and safety information carefully.



This appliance is not intended for use by persons (including children) with reduced physical, sensory or mental capacities, or by persons lacking in experience or knowledge, unless they are supervised or instructed on the use of this device by a person responsible for their safety. Children should be supervised to ensure they do not play with this device.

Keep this user manual for future reference or product sharing carefully. Do the same with the original accessories for this product. In case of warranty, please contact the dealer or the store where you bought this product.

Enjoy your product. * Share your experience and opinion on one of the well-known internet portals.

Specifications are subject to change without notice - please be sure to use the latest manual available on the manufacturer's website.

Table of Contents

Hints	2	How to charge	6
Safety instructions	2	How to use	7
Safety rules for rechargeable batteries.....	3	Cleaning and Maintenance.....	7
Warnings	4	Common Faults and Analysis.....	8
Disclaimer.....	4	Technical specifications	8
Features	5	Support.....	9
Product overview.....	6	Declaration of Conformity.....	9
		Disposal.....	9

Hints

● Only use the product for purposes due to its intended function ● Do not damage the product. Following cases may damage the product: Incorrect voltage, accidents (including liquid or moisture), misuse or abuse of the product, faulty or improper installation, mains supply problems including power spikes or lightning damage, infestation by insects, tampering or modification of the product by persons other than authorized service personnel, exposure to abnormally corrosive materials, insertion of foreign objects into the unit, used with accessories not preapproved. ● Refer to and heed all warnings and precautions in the user manual.

Safety instructions

- When charging appliances, the output terminal DC 5V / 2A must be used (the maximum power measured at the output terminal is less than 15W), An adapter that meets the requirements of GS standard is used to charge appliances.
- Do not use this product to suck detergent, inflammable liquids, glass shards, needles. cigarette ash, wet dust, sewage, matches and other substances and liquids.
- Do not use this product to absorb small particles such as cement, gypsum powder or larger objects such as toy paper balls, otherwise it may cause malfunctions such as mite vacuum cleaner blockage and motor burnout
- Do not use this product near flammable or explosive gases, high temperatures, or in hazardous environments.
- When using this product, pay attention to installing the filter element component.
- Regularly clean the mite vacuum cleaner filtration system.
- Do not pour or splash water or other liquids into the device to avoid causing a short circuit and burning out the device.

- When storing the device for a longtime without using it, ensure that it is charged and discharged at least once every three months.
- When your mite vacuum cleaner is fully charged, needs cleaning or maintenance, turn it off and disconnect the charging power first.
- Do not use liquid cleaners or cleaning sprays. The product may only be cleaned with a damp cloth.
- Do not immerse this product in water or any other liquid to avoid damage to the product and personal injury.
- Do not use the product in direct sunlight or places where the temperature may exceed 50°C for a long time.
- This product is not a toy, and children are prohibited from playing with it as a toy.
- Keep fingers or any other body parts away from the rolling brush during use to prevent injury.
- Do not attempt to disassemble this product, as unauthorized disassembly will void the warranty.
- Never touch the product with wet or damp hands.
- The product can only be operated with the voltage described on the sticker.
- The cable is sheathed and insulates the current. Do not place any objects on the cable, as this could cause the protective function to be lost. Avoid placing excessive stress on the cable, especially at sockets and plugs.
- Do not insert any objects into the openings of the unit, as current flows in some places and contact may cause fire or electric shock.
- Do not connect any additional devices that are not recommended by the manufacturer.

Safety rules for rechargeable batteries

The product uses rechargeable batteries and can go wherever you need them. But ALL batteries can EXPLODE, CATCH FIRE, and CAUSE BURNS if disassembled, punctured, cut, crushed, short-circuited, incinerated, or exposed to water, fire, or high temperatures, so you must handle them with care.

To use the rechargeable batteries safely, follow these guidelines:

- ALWAYS follow local waste and recycling laws when throwing used batteries away.
- ALWAYS use the product to charge the rechargeable batteries.
- NEVER place the rechargeable batteries in a pocket, purse, or other receptacle, especially those containing metal objects.
- NEVER store the rechargeable batteries with hazardous or combustible materials.

- NEVER let the rechargeable battery or battery compartment get wet - before, during, or after installation. (Remember, your product itself is weatherproof, but its interior battery compartment and batteries aren't.)
- NEVER disassemble, cut, crush, puncture, short-circuit, dispose of batteries in fire or water, or expose the rechargeable battery to temperatures above 50°C.

Warnings

- Do not disassemble the product, it may result in short-circuit or damage.
- Battery life-span will decrease with usage. Charge the battery at least once every month to preserve battery in the event the product is not used for long time.
- Battery warning: Improper use of the battery may cause fire or chemical burns. The battery may explode in case of damage.
- Do not modify, repair or remove without professional guidance.
- Do not use corrosive or volatile liquid for cleaning.
- Do not drop or shake the device, it may break internal circuit boards or mechanics.
- Keep the device away from little children.

Disclaimer

- In no event shall Technaxx Deutschland be liable for any direct, indirect punitive, incidental, special consequential damage, to property or life, improper storage, whatsoever arising out of or connected with the use or misuse of their products.

Features

- Cord-Free Convenience: No power outlet or cable restrictions (rechargeable battery 2000mAh up to 20 minutes run time)
- Disinfection: Kills up to 99.9% of mites, bacteria, and viruses using shortwave UV-C light.
- Mite Disruption: Ultrasound waves interfere with mite development and behavior.
- Chemical-Free: Uses physical methods only, no harmful substances.
- Strong Suction: Powerful enough to remove mites, skin flakes, and fine dust.
- Ideal For: Mattresses, pillows, bedding, sofas, upholstery, carpets, etc.
- Lightweight: 1.3 kg – easy to maneuver.
- Compact Design: Convenient to store and carry.

Product overview

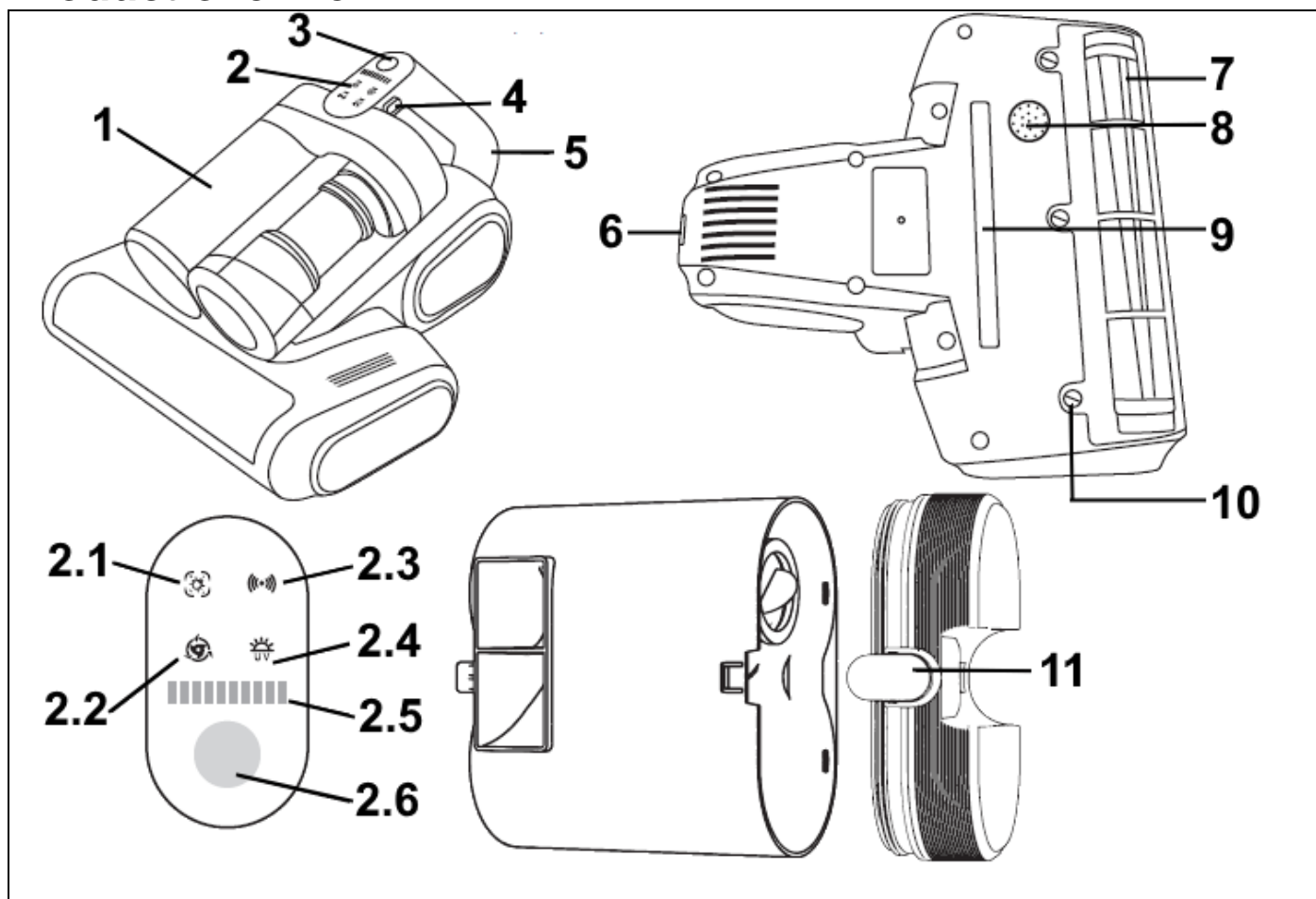

1	Dust collection cup	4	Dust cup removal button
2	Display	5	Handle
2.1	Mite removal	6	Charging port
2.2	Rolling brush	7	Rolling brush
2.3	Ultrasonic	8	Ultrasonic
2.4	UV sterilization	9	UV-C LED
2.5	Battery indicator	10	Roll brush lock buckle
2.6	Power button	11	Dust cup lid removal button
3	Power button		

How to charge

- Connect the Type-C charging cable to a USB adapter, plug the adapter into an indoor power outlet, and insert the Type-C plug of the charging cable into the charging port at the cleaner, making sure it is fully inserted
- The battery indicator light will flash while charging.
- When fully charged, the battery indicator light will turn steady.
- It takes approximately 3-4 hours to fully charge.

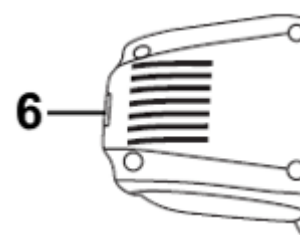

PRECAUTIONS

- Before connecting to the power source, make sure the adapter, charging cable plug and the charging port on the device are completely dry.
- Always ensure that the device is disconnected from the power supply if it is to be left unattended. Before each use, check that the appliance and cord are in good condition. Never use an appliance if the cord is damaged.
- Adapter is not included with this product. Charge with GS or equivalent safety approved adapters with output voltage of 5V DC
- Low battery warning: If battery indicator is flashing during use, it means low battery. Charge the cleaner as soon as possible.
- This is a lithium-battery rechargeable product, when not in use, it is recommended to charge every three months to ensure service life of the battery.

How to use

1. Power button: Press and hold this button (3) for 2 seconds to turn on the device. The digital display screen will show the running function, the scrolling light will show the battery level and the rolling brush ultrasonic sterilization and mite removal indicator light will light up. The device will default to low gear operation.
2. Short press this button (3) to switch between gears, with a total of two gears. Cycle between first and second gear.
3. Press and hold this button (3) again for 2 seconds to turn off the device and enter standby mode.
4. Dismantling of dust collection cup: Press the button (4) to open the dust cup and the dust cup will automatically bounce out. Remove the dust cup, press the button (11) and remove the filter element inside for cleaning. When installing, align with the hole position and press down to complete the installation.

Cleaning and Maintenance

1. Shut down and disconnect the charging power before cleaning.
2. Remove the dust collecting cup. Take out the filter from the dust cup cavity. Dump the garbage in the dust bin. Wash the dust cup cavity with clean water if necessary. After the dust cup cavity is washed it must be completely dry before reloading.
3. Take the filter handkerchief out of the chamber of the dust cup, gently knock off the dirt attached to the handkerchief for rinse it with clean water and dry it. Do not wash it with a brush to avoid damaging the filter.
4. If the filter frame is damaged, replace it in time.

5. After washing, the filter components must be completely dried before being reinstalled.
6. After cleaning, store it in a dry and ventilated place out of reach of children.

Common Faults and Analysis

Symptoms	Cause analysis	Resolvent
Unable to start	Low power	Recharge and restart
	Start without pressing the ON/standby/Gear key	Press the on/standby/gear key again to start the device
The suction of the device becomes smaller	The dust collecting cup is full	Clean the dust collecting cup
	The filter is blocked by garbage	Clean the filter
	The suction port of the device is blocked	Clean the blockage at the suction port
The device cannot be charged	The charging cable is not connected properly	Reconnect the charging cable
	The charging cable is damaged	Replace and purchase a new original charging cable

Technical specifications

Rated power	120W
Suction power	10W (10000pa)
Power supply	USB-C 5V / 2A
Battery	Li-Ion 18650, 2000mAh, 11.1V
Charging time	3-4h
Working time	1st gear 23 minutes; 2nd gear 16 minutes
Working voltage	DC 11.1V
Dust collection capacity	520ml
Air flow rate	ca. 1–1,5 m ³ /min
Filter type	H13 or H14, Zyklon-Filter
Type	UV-C LED
Wavelength	253.7 nm
UV output	4-10 W
UV lamp service life	approx. 5,000-10,000 hours
Volume	<70 dB (quiet operation)
Material	ABS
Weight & Dimensions	1.3kg / (L) 29.5 x (W) 27.0x (H) 18.5cm

Package contents	Cordless Mite Vacuum Cleaner LX-068, Filter, USB-C cable, user manual
------------------	---

Support

Service phone No. for technical support: **01805 012643** (14 cent/minute from German fixed-line and 42 cent/minute from mobile networks). Free

Email: **support@technaxx.de**

The support hotline is available Mon-Fri from 9am to 1pm & 2pm to 5pm

In the event of anomalies and accidents, please contact: **gpsr@technaxx.de**

Declaration of Conformity



Technaxx Deutschland GmbH & Co. KG hereby declares that the equipment type LX-068 Prod. ID.:5340 is in compliance with Directive 2014/30/EU. The full text of the EU Declaration of Conformity is available at the following internet address: www.technaxx.de/reseller

Disposal



Disposal of the packaging. Sort packaging materials by type upon disposal.

Dispose of cardboard and paperboard in the waste paper. Foils should be submitted for recyclables collection.



Disposing of old equipment (Applies in the European Union and other European countries with separate collection (collection of recyclable materials) Old equipment must not be disposed of with household waste! Every consumer is required by law to dispose of old devices that can no longer be used separately from household waste, e.g. at a collection point in his or her municipality or district. This ensures that the old devices are properly recycled and that negative effects on the environment are avoided. For this reason, electrical devices are marked with the symbol shown here.



Batteries and rechargeable batteries must not be disposed of in household waste! As a consumer, you are required by law to dispose of all batteries and rechargeable batteries, whether they contain harmful substances* or not, at a collection point in your community/city or with a retailer, to ensure that the batteries can be disposed of in an environmentally friendly manner. * marked

with: Cd = cadmium, Hg = mercury, Pb = lead. Return your product to your collection point with the fully discharged battery installed inside!

Made in China

Distributed by:
Technaxx Deutschland GmbH & Co. KG
Konrad-Zuse-Ring 16-18,
61137 Schöneck, Germany

Cordless Mite Vacuum Cleaner LX-068