

Technaxx® * User Manual

Wi-Fi Peephole Camera TX-366

Before using the appliance for the first time, please read the instructions for use and safety information carefully.



This appliance is not intended for use by persons (including children) with reduced physical, sensory or mental capacities, or by persons lacking in experience or knowledge, unless they are supervised or instructed on the use of this device by a person responsible for their safety. Children should be supervised to ensure they do not play with this device.

Keep this user manual for future reference or product sharing carefully. Do the same with the original accessories for this product. In case of warranty, please contact the dealer or the store where you bought this product.

Enjoy your product. * Share your experience and opinion on one of the well-known internet portals.

Specifications are subject to change without notice - please be sure to use the latest manual available on the manufacturer's website.

Table of Contents

Hints	2	RESET Button	6
Safety instructions	2	Quick operation guide	7
Warnings	3	Preparation	7
Notes on data protection	3	Get App	7
Disclaimer	4	Create account / Register ...	7
Features	4	Add device	8
Product overview	5	Mounting	10
Display	5	FAQs	12
Camera	5	Technical Specifications	13
General information	6	Support	14
Charging	6	Care and maintenance	14
MicroSD card	6	Declaration of Conformity	15
IR LED	6	Disposal	15
Indicator lamp	6		

Hints

● Only use the product for purposes due to its intended function ● Do not damage the product. Following cases may damage the product: Incorrect voltage, accidents (including liquid or moisture), misuse or abuse of the product, faulty or improper installation, mains supply problems including power spikes or lightning damage, infestation by insects, tampering or modification of the product by persons other than authorized service personnel, exposure to abnormally corrosive materials, insertion of foreign objects into the unit, used with accessories not preapproved. ● Refer to and heed all warnings and precautions in the user manual.

Safety instructions

- The product is intended for the recording of digital photos and videos. It is intended for use by private individuals.
- Never touch the product with wet or damp hands.
- The product can only be operated with the voltage described on the product.
- Do not place the product on an unstable surface. The unit could be damaged or persons could be injured. Any attachments should be made only in accordance with the manufacturer's instructions or obtained from the manufacturer.
- The cable is sheathed and insulates the current. Do not place any objects on the cable, as this could cause the protective function to be lost. Avoid placing excessive stress on the cable, especially at sockets and plugs.

- If you want to pull the plug out of the socket, always pull on the plug and not on the cable. The cable could otherwise break.
- Do not overload wall outlets, extension cords, or other wiring as this may result in fire or electric shock.
- Do not insert any objects into the openings of the unit, as current flows in some places and contact may cause fire or electric shock.
- Unplug the power cord from the power outlet for cleaning.
- Do not use liquid cleaners or cleaning sprays. The product may only be cleaned with a damp cloth.
- Do not connect any additional devices that are not recommended by the manufacturer.
- Do not use the product in direct sunlight or places where the temperature may exceed 60°C for a long time.

Warnings

- Do not disassemble the product, it may result in short-circuit or damage.
- Do not modify, repair or remove without professional guidance.
- Do not use corrosive or volatile liquid for cleaning.
- Do not drop or shake the device, it may break internal circuit boards or mechanics.
- Keep the device away from little children.

Notes on data protection

- Personal rights: When setting up the camera, be sure to respect the personal rights of the people around you. Under no circumstances may you set up the camera in such a way that people who happen to enter the recording area of the camera are recorded in such a way that they can be identified in any way! This also applies to the recognizable recording of vehicle license plates.
- Do not monitor public areas: Observe all national laws and regulations regarding the legality of recording in public areas (streets, sidewalks, parking lots, etc.) by private persons. Refrain from using the camera in such an environment that is in defiance of the law.
- No workplace monitoring: Observe all national laws and regulations regarding the legality of recording at the workplace by an individual. Refrain from using the camera in the workplace in a way that is in defiance of the law. Under no circumstances may you use the camera to monitor your use the camera for employee monitoring! Surveillance in the workplace is subject to particularly strict conditions in Germany.
- Delete recordings: Photos or videos of recorded people whose consent you do not have or that have not been informed, must be deleted immediately.

● Property protection: If using the camera for property surveillance or to investigate administrative offenses or crimes, ensure that only a perpetrator and not, for example, uninvolved persons are recorded.

● Handover to investigating authorities: Only if a misdemeanor offence has been committed, you may only hand over the recordings to the investigating and only to them. The investigating authorities will then decide on the further use of the recordings.

Note: Different laws may apply depending on the federal state. Seek professional legal advice in case of doubt.

Disclaimer

● In no event shall Technaxx Deutschland be liable for any direct, indirect punitive, incidental, special consequential damage, to property or life, improper storage, whatsoever arising out of or connected with the use or misuse of their products. ● This device is NOT intended to be used for illegal surveillance purposes and shall not be used in any form as evidence for claim purpose. ● Error messages may appear depending on the environment it is used in. ● Technaxx Deutschland is not liable/responsible for non- recording of events, missing files, etc.

Features

- 3MP video quality, live stream and watch recordings
- 4.3" (10.92cm) HD LCD display (480P)
- Support 1 & 2-way audio between phone and camera
- Built-in Lithium Battery 5000mAh; 600 rings = up to 2 months
- Easy charged by Type C
- Motion detecting distance up to 3m
- Wide viewing angle, see more of every moment
- WiFi wireless connection 2.4GHz
- Support local storage by MicroSD card up to 32GB
- Free APP provided, support remote viewing on iOS or Android

Product overview

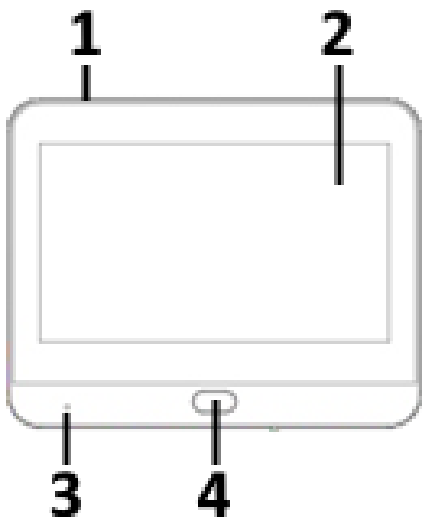
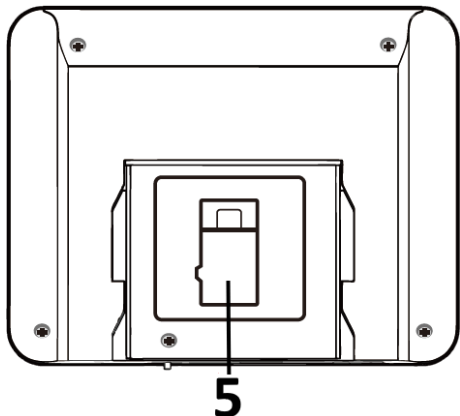
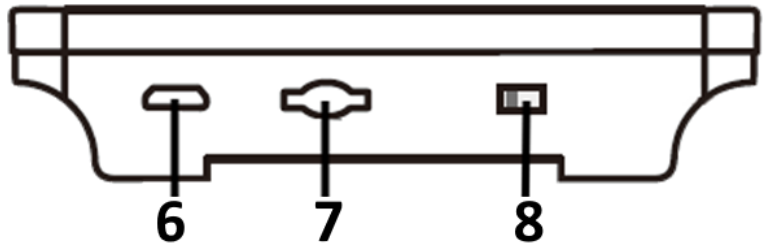
Display			
Front	Back		
			
Bottom			
			
1	Built-in battery	5	Data cable connector
2	Display 4.3" (10.92cm)	6	Power input (5V/1A)
3	Indicator lamp	7	MicroSD Card Slot
4	Wake up button (Reset; 5s hold)	8	ON / OFF switch

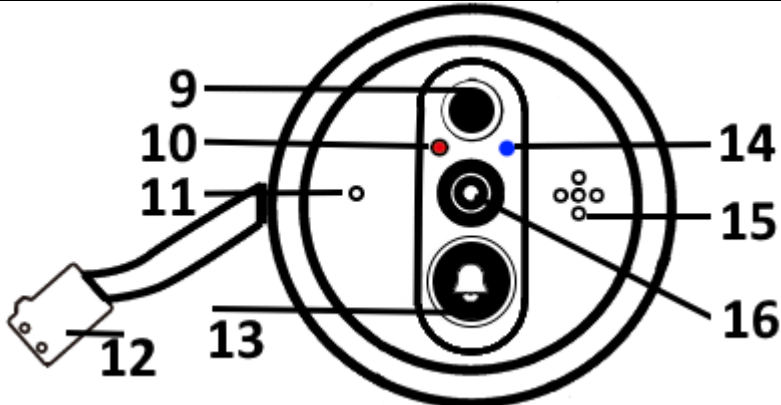
Camera			
			
9	PIR sensor	13	Doorbell button
10	IR LED (1pcs, 940nm)	14	Light sensor
11	Microphone	15	Speaker
12	Data cable	16	Lens

General information

Charging

1. Connect a power adapter* (*not included) to the display power port, using the included USB-C cable.
2. Charge the device until the red LED gets green.
3. First charge takes up to 5hours.

MicroSD card

Insert the MicroSD card with the notches facing towards you while you look at the display.

Note: Take care while inserting the MicroSD into the slot. Otherwise, it could happen that you put the MicroSD into the device instead of into the MicroSD slot.

Supports MicroSD card for local storage (max. 128GB). To guarantee the normal use of MicroSD card, before inserting the MicroSD card, make sure its file system is FAT32 for 4-32GB and exFAT for 64-128GB. Check if there is more than 256MB space available.

For 64-128GB MicroSD cards it might be necessary to format the MicroSD card after inserting and configuration via the App.

IR LED

The device activates the infrared light automatically as soon as low illumination prevails. With the IR LEDs shining at night you get black/white images/recordings at night.

Indicator lamp

LED	Operation
Blue flashing	Wi-Fi configuration mode
Blue steady	1. Motion detected 2. Remote access 3. 1- or 2-way call
Blue off	Standby
Red steady	Charging
Green steady	Fully charged

RESET Button

Press and hold the Wake up button on the display for 5 seconds to reset the device.

Quick operation guide

TX-366 camera can only be configured by iOS or Android APP!

Preparation

Insert a MicroSD card* into the MicroSD card slot for saving recordings (*not included).

Note: A MicroSD card should be inserted into the camera before it can be operated. Before inserting or removing the MicroSD card, the camera must be in OFF Mode. Failing to do so may cause loss of or damage to the videos already recorded on the MicroSD card.

Get App

→ To download the App Tuya Smart (or Smart Life) from the Appstore or the Playstore search for “Tuya Smart” or scan the QR-code below.

[iOS 15.0 or above; Android 13.0 or above (12-2025)]

		
APP icon	iOS	Android

Create account / Register

→ Open the Tuya Smart App on your device.

→ Register Account.

1. On the login interface, click on Sign Up, enter your email, tick the box for data protection and terms of use.
2. Press on verification code send.
3. Enter the verification code send to your email.
4. Enter an account password.
5. Click on Confirm to create an account and login.

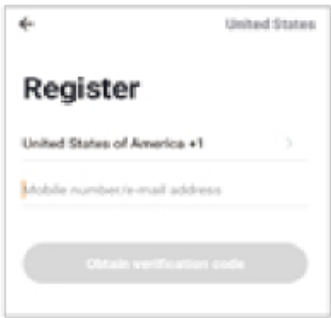
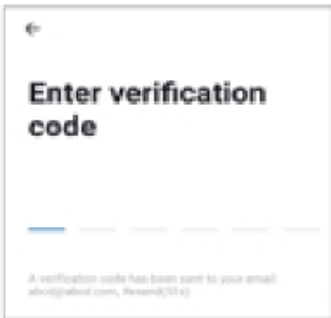
	
1	2

Add device

Know your Wi-Fi network and password. Make sure your mobile device is running iOS15 or higher or Android 13 or higher. Make sure you're connecting to a 2.4GHz Wi-Fi network (It can't connect to 5GHz networks).

- Make sure Wi-Fi is available and connected to the Internet.
- Connect the camera to the power, then system startup completed.
- Open "Tuya Smart" APP, press the '+' in the upper right corner of the main screen. Choose "Camera & Lock", click "Smart Doorbell" (Figure 01) to add camera.
- Hold down the Wake-up button of the screen for 5 seconds to reset and initiate the Wi-Fi configuration mode. Once you hear a voice prompt, press on "Next"

Note that only 2.4 GHz Wi-Fi network is supported

If the mobile phone is not connected to Wi-Fi, click "Connect to Wi-Fi: It will jump to the Wi-Fi interface and connect to Wi-Fi.

- If the phone is connected to Wi-Fi (Figure 02) Wi-Fi data is added. Then click on "Next".
- Otherwise manually edit the Wi-Fi data corresponding to your home Wi-Fi network. Then click on "Next".
- A QR-code will prompt on your screen and you need to scan it with the TX-366 camera. (the camera lens is about 15-20 cm away from the mobile phone screen).
- Then click "I heard a prompt" (Figure 03).

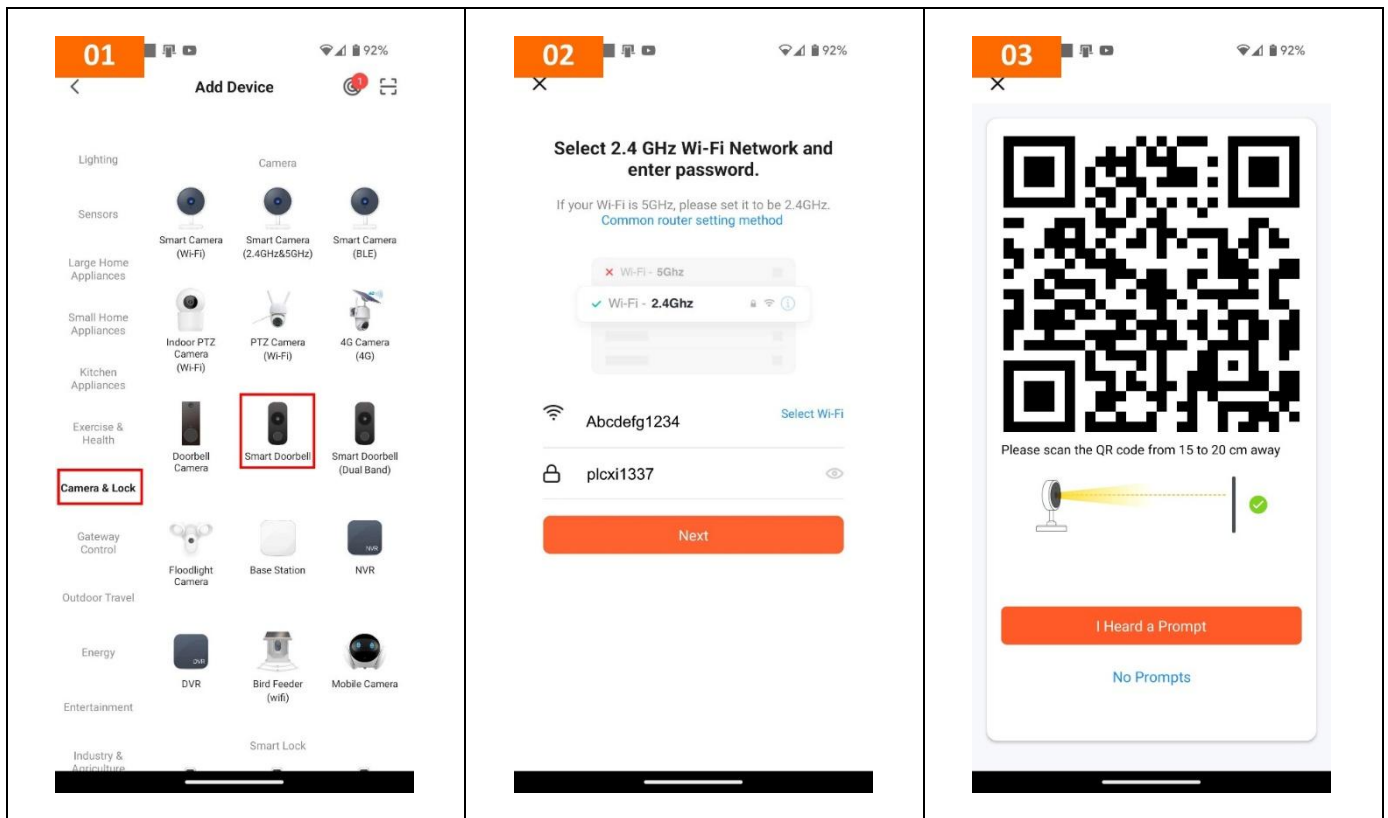

- "Connecting" (Figure 04). You will hear the following prompts:
 1. "Connect router"
 2. "Connect internet"
 3. "Add device success"
- Connection completed (Figure 05) and click "Done".
- Then jump to preview interface (Figure 06).
- After closing the device preview interface, the interface returns to the APP home page.
- At this time, the connected device will appear on the APP home page. Then you can click directly to the device interface to see the live modus without re-adding afterwards.

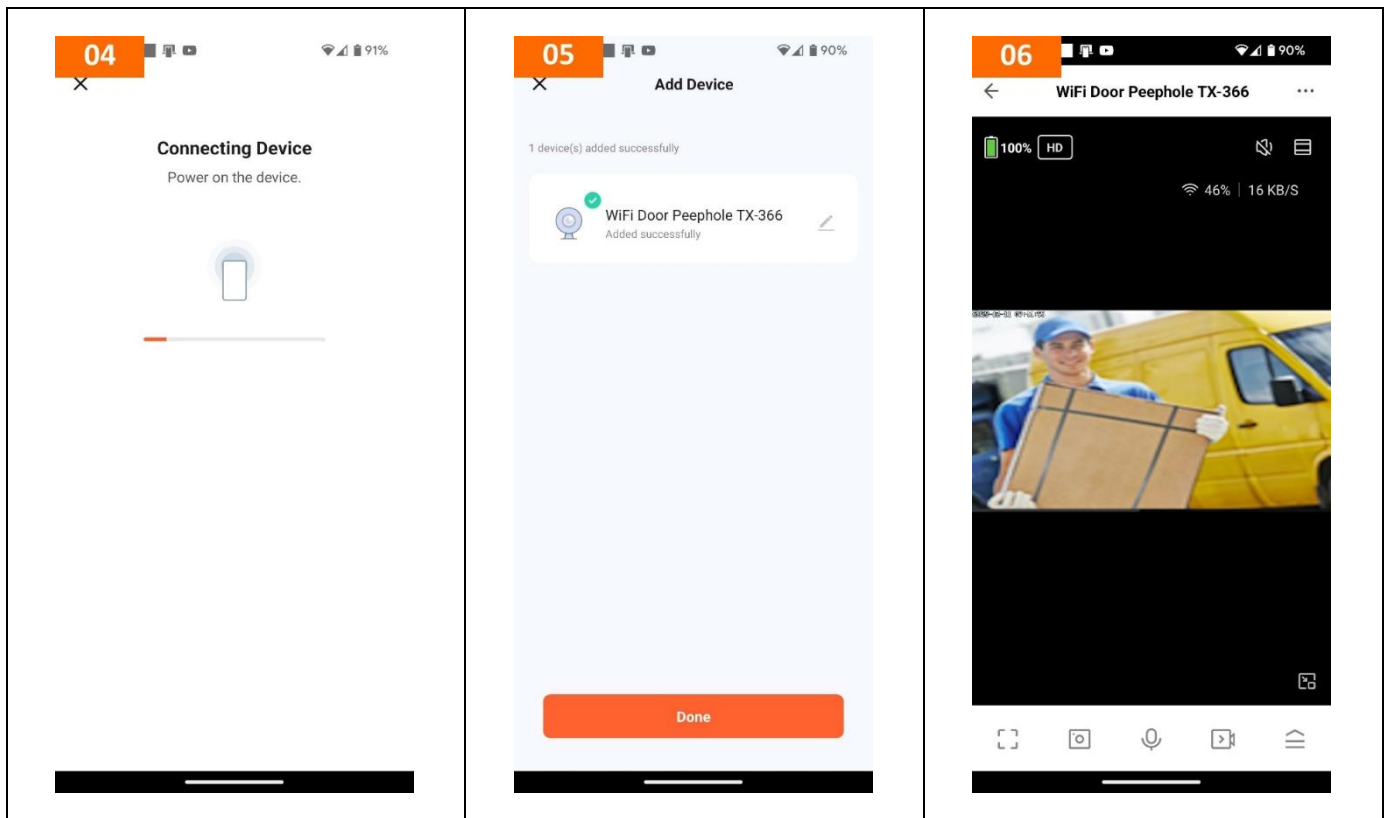

Mounting

NOTE:

1. The door needs to be at least 40mm in thickness.
2. The max. thickness of the door is 115mm.
3. The product connecting wire is a vulnerable and precise component. You should check the position of the fixing metal plate during installation when you install the screws. Prevent the connecting wire from being squeezed and do not forcefully pull the connecting wire.
4. Any operation must be completed in the shutdown state. The connecting cable contains multiple data transmission, **DO NOT COMPRESS!**
5. After configuring the Wi-Fi connection, install it to your door.
6. Connect the camera and the display in the correct direction.

Peephole replacement	New installation
Step1: Remove the old peephole, min diameter 15mm.	Step1: Drill a hole through the door, diameter min. 15mm
Step2: Put the two screws into the camera module holes.	

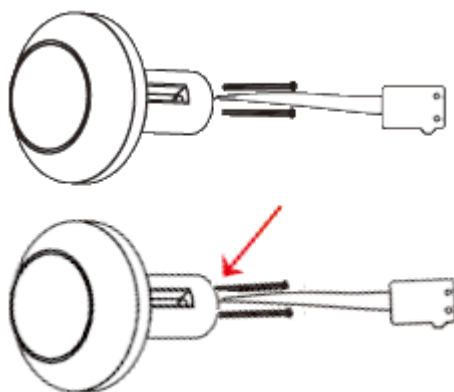

Step3:

Take the cable through the door's hole and through the mounting plate. Then tighten the screws.

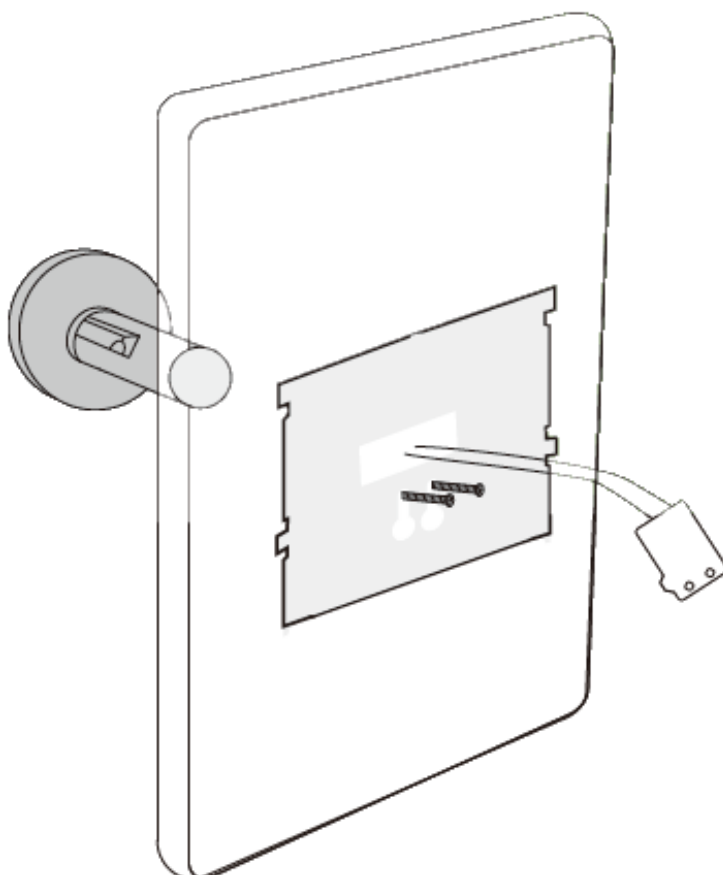

Step4:

Plug the data cable and the buckle into the correct location of the LCD display. Hang it onto the steel plate.

Note:

1. Do not pull the cable too hard during installation!
2. The cable contains data transmission, do not fold it!

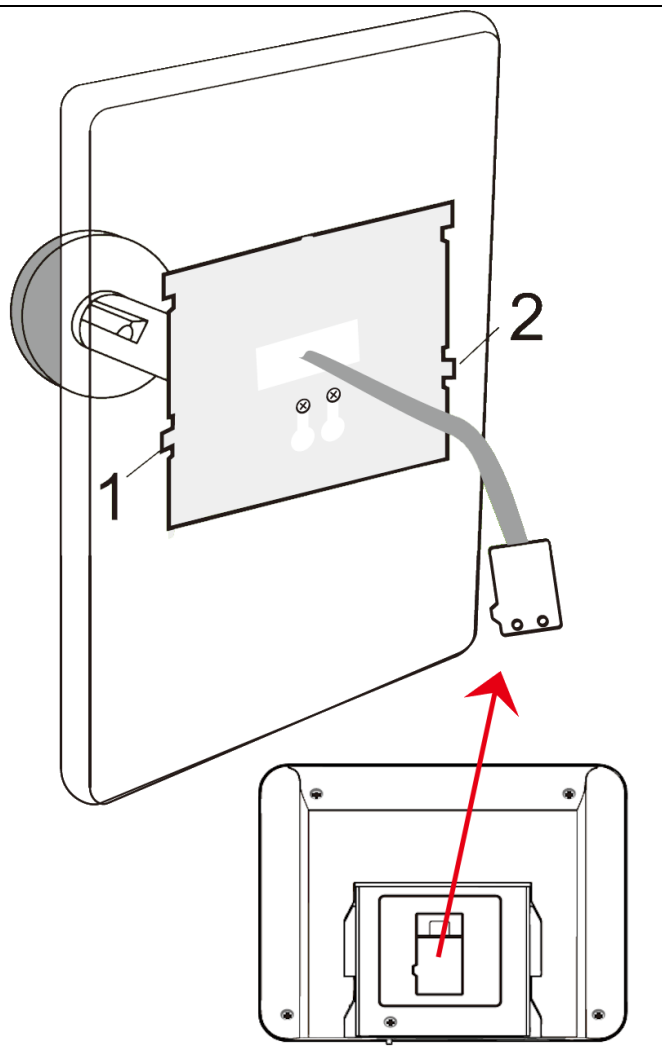
**FAQs**

Q1: Can I share with family and friends?

A1: Yes, you can share your cameras with family and friends who will have access to view the camera and control your bulbs, plugs, and other devices. In the app, press the Profile button and click on the “Home Management*” button and you will be able to give or revoke sharing permissions. In order to share the other user should already have downloaded the app and registered a new account.

Q2: What is the Wireless distance?

A2: The range of your home Wi-Fi is heavily dependent on your home router and the conditions of the room. Check with your router specifications for exact range data.

Q3: How many cameras can I control?

A3: Tuya Smart app can control an unlimited amount of devices in an unlimited amount of locations. Your router may have a limit of how many devices can be connected to one router.

Q4: My device cannot be connected to network with App.

A4: Make sure the device is under the config status (indicator light is flashing quickly).

Make sure the Wi-Fi is available and not too far away from router.

Make sure the Wi-Fi password you input is correct.

Q5: My device shows offline in my App.

A5.1: Make sure the device is powered on.

Make sure the network is stable and the Wi-Fi name and password not modified. If not, add device again.

If the network is normal, but it's still offline. Check if there are too many Wi-Fi connections, you can restart your router to check the status of the device.

A5.2: Ensure the device is properly charged.

Q6: How to charge?

A6: After installation, do not remove the product for charging unless necessary to avoid damaging the product. If charging is inconvenient, we advise using a portable charger for charging.

Use a national standard 5V power supply. Device does not support fast charging, do not use a high-power fast charging to avoid burning the main board.

Q7: The Wi-Fi configuration failed.

A7: Notice the product's voice when you configure Wi-Fi. If connection fails check the Wi-Fi password, 2.4GHz Wi-Fi frequency and the router enabled for DHCP, firewall, black and white list, anti phishing network functions, MAC filtering and related settings.

Technical Specifications

Image sensor	3MP 1/3" Color CMOS
Lens	f=2.5mm, fixed focus
Viewing angle	FOV:142° / 121°(H)
Day & Night	Auto. IR-cut filter
Minimum illumination	0.01 Lux (with infrared led on)
IR distance	1-3m / 1pcs 940nm IR LED
Video resolution	2304x1296 pixel
Video frame rate	20fps
Display size	4.3" (10.92cm); 480x272 pixel
Video compression	H.265
Microphone & Speaker	Built-in
Network	2.4 GHz 802.11b/g/n

WiFi security	WEP / WPA / WPA2
WiFi distance	Max. 15m (open field)
Radiated output power max.	100mW
Motion detection distance	1-3m (open space)
PIR Motion Detect	Yes (If PIR on, only 1200 trigger with full battery!!!)
Storage	Supports MicroSD (HC/XC) cards up to 32GB (FAT32) (class10)
Battery	Built-in, rechargeable Li-Ion 3.7V, 5000mAh; 600 rings; with 10 triggers per day, the battery lasts up to 2 months
Power consumption	Working mode: 380mA (IR on) Standby mode: 200µA
Input power	DC 5V / 1A, USB-C
Length USB-C cable	3m
Length data cable	145mm
Door thickness	Min. 40mm; max. 115mm
Weatherproof	No
Working condition	-20 - 55°C; RH Less than 85% (No condensation)
App "Tuya Smart"	iOS 15.0 or above; Android 13.0 or above / EN, DE, FR, ES, IT, NL, SE, DK, NO, FI, CZ, PO (12-2025)
User accounts	Total 4 Users (Admin user and normal user)
Material	ABS Plastic, Aluminum Alloy
Weight / Dimension Display	207g / (H) 11.2 x (L) 8.9 x (L) 2.5cm
Weight / Dimension Camera	115g / (L) 5.3 x (Ø) 6.5cm
Package contents	Wi-Fi Peephole Camera TX-366, USB-C cable (3m), Screws, Mounting plate, User manual

Support

Service phone No. for technical support: **01805 012643** (14 cent/minute from German fixed-line and 42 cent/minute from mobile networks). Free Email: **support@technaxx.de**

The support hotline is available Mon-Fri from 9am to 1pm & 2pm to 5pm

In the event of anomalies and accidents, please contact: **gpsr@technaxx.de**

Care and maintenance

Clean the device only with a dry or slightly damp, lint-free cloth.
Do not use abrasive cleaners to clean the device.

This device is a high-precision optical instrument, so in order to avoid damage, please avoid the following practice:

- Use the device in ultra-high or ultra-low temperature.
- Keep it or use it in moist environment for long.
- Use it in rainfalls or in water.
- Deliver or use it in strongly shocking environment.

Declaration of Conformity



Technaxx Deutschland GmbH & Co. KG hereby declares that the radio equipment type TX-366 Prod. ID.:5383 is in compliance with Directive 2014/53/EU. The full text of the EU Declaration of Conformity is available at the following internet address: www.technaxx.de/reseller

Disposal



Disposal of the packaging. Sort packaging materials by type upon disposal.

Dispose of cardboard and paperboard in the waste paper. Foils should be submitted for recyclables collection.



Disposing of old equipment (Applies in the European Union and other European countries with separate collection (collection of recyclable materials) Old equipment must not be disposed of with household waste! Every consumer is required by law to dispose of old devices that can no longer be used separately from household waste, e.g. at a collection point in his or her municipality or district. This ensures that the old devices are properly recycled and that negative effects on the environment are avoided. For this reason, electrical devices are marked with the symbol shown here.

Made in China

Distributed by:

Technaxx Deutschland GmbH & Co. KG
Konrad-Zuse-Ring 16-18,
61137 Schöneck, Germany

Wi-Fi Peephole Camera TX-366