

Technaxx® * User Manual

Jump Starter 10000mAh TX-78

The Declaration of Conformity for this device is under the Internet link: www.technaxx.de/ (in bottom bar "Konformitätserklärung"). Before using the device the first time, read the user manual carefully. **This device has a rechargeable battery. It must be fully charged before first use.**

NOTE: Charge the battery of the device every 2-3 month if it is not used!

Service phone No. for technical support: 01805 012643 (14 cent/minute from German fixed-line and 42 cent/minute from mobile networks). Free Email: support@technaxx.de

Important Hints * This device is only suitable for CARS (12V) !

- This device has 5 indicator lights (= LED). When only 3 LEDs are shining, or less, then do NOT use the device to start your car ! But you can use it for charging digital devices.
- When trying to start your car more than 3x without success, stop starting it. Disconnect the device to avoid damaging other parts of the car.
- Check the power of the device 1x per month and also charge it to ensure it can work in an emergency case.
- Do NOT use the device all the time for charging. Maybe then it will not have enough power for starting a car in an emergency situation.
- Device shuts down automatically when it is not loading other external devices.

Features

- 3-in-1 Power Bank: Jump Starter for the car battery, Charging (e.g. Smartphone, Tablet PC, etc.), Emergency Light
- Jump start: diesel cars up to 3L engine, gasoline/petrol cars up to 5L engine
- Integrated emergency light (3 lighting effects)
- Built-in protection against overcurrent, short circuit, overload/-charge and overvoltage
- 2 USB outputs for simultaneous charging of two devices
- 4-in-1 charging cable supports Micro USB & Mini USB & Lightning & 30-pin connector
- Ideal size to fit into the inner front glove compartment

Technical specifications

Jump Start output	12V output for starting a car
Starting current / Peak current	300A / 400A
Input voltage	at home 15V/1A, in a car 12V/1A
Output (USB ports)	5V/1A and 5V/2A
Battery Clamps	Input: DC 10.8-15V 400A, Output: DC 12V 400A
Battery	Lithium polymer battery 10000mAh 3.7V / 36.63Wh / Charging time ~4 hours
When device is fully charged it can charge iPhone 6S ~3 times	
When device is fully charged it can be used ~200 times	
Operating temperature	0°C up to +60°C
Storage temperature	-10°C up to +60°C
Weight / Dimensions	385g / (L) 16.5 x (W) 7.3 x (H) 2.8cm
Package Contents	Jump Starter 10000mAh TX-78, 4-in-1 USB cable, Jump Starter cable with battery clamps, Home charger, Car charger, User Manual
Keep this manual for future reference or product sharing carefully. Do the same with the original accessorie(s) for this product. In case of warranty, please contact the dealer or the store where you bought this product . Warranty 2 years	

Product View

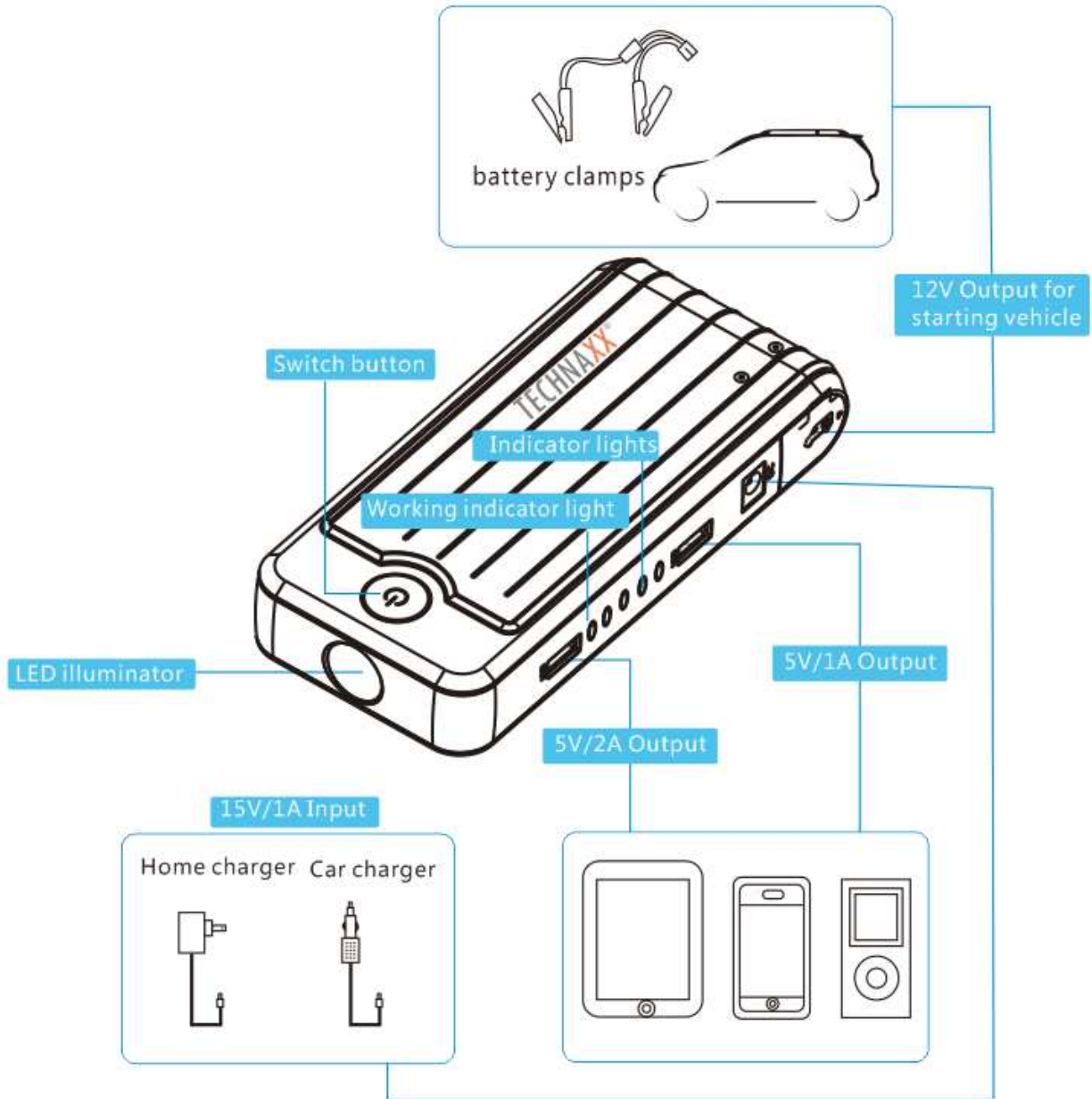

Battery clamps
12V Output for starting car
Switch button
Indicator lights = Capacity status LEDs (BLUE)
Working indicator light = Charging status LEDs (RED)
15V/1A Input
Home charger / Car charger
5V/2A USB output
5V/1A USB output

Switch button and power indication instructions

(1) Press the SWITCH button 1x, check the balance power and start the product.

(2) Press the SWITCH button for 2–3 seconds to activate the LED flasher. The 3 modes of LED lights appear in sequence (Strobe, SOS, Fast flashing warning, Off). Press short the switch button to turn off the device. **This device has intelligent shutdown, means, when it is fully charged and no other device is connected to it for external charging, then it shuts down automatically to save its energy.**

(3) **Balance power indication** → Press the SWITCH button. Then the power indicator lights are on. → 5 LEDs are lighting in BLUE, balance power is about 100% → 4 LEDs are lighting in BLUE and 1 LED in RED, balance power is about 80% → 3 LEDs are lighting in BLUE and 2 LEDs in RED, balance power is about 60% **(From this capacity status on, please do not start your car any longer with the TX-78!)** → 2 LEDs are lighting in BLUE and 3 LEDs in RED, balance power is about 40% → 1 LED is lighting in BLUE and 4 LEDs in RED, balance power is about 20% → 1 LED is lighting in RED, balance power is about 10% → NO LED is lighting, balance power is about 0%.

(4) **Charging power indication** → Connect the charger to the device and then the power indicator lights flash. → 1st LED flashes, charging power is about 0%–10% → 2nd LED flashes, charging power is about 10%–20% → 3rd LED flashes, charging power is about 20%–40% → 4th LED flashes, charging power is about 60%–80% → When 5 LEDs are on, the device is fully charged.

Power indicator lights	○ ○ ○ ○ ○	⊗ ○ ○ ○ ○	● ⊗ ○ ○ ○	● ● ⊗ ○ ○	● ● ● ⊗ ○	● ● ● ● ⊗	● ● ● ● ●
Corresponding power	0%	10%	≤20%	≤40%	≤60%	≤80%	100%
○ : OFF ⊗ : Flash ● : ON							

Use the 15V/1A home charger or the 12V/1A car charger to charge the device, when all 5 LEDs are on (that means the device is fully charged). Disconnect the device to save the power.

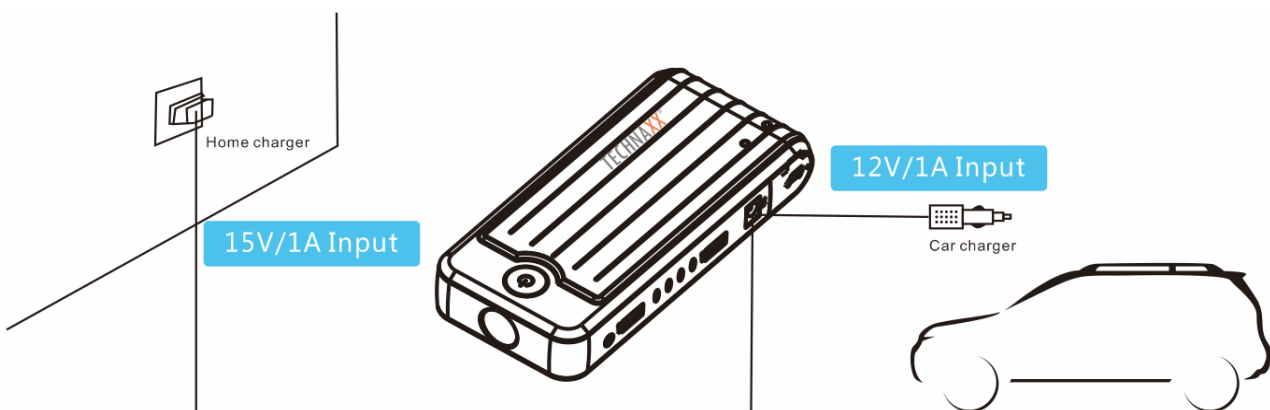

(5) Jump Start (start-up aid) of vehicles with a 12V-on board network

ATTENTION: During the starting process of a car with the TX-78, neither charge any other devices over the USB connection, nor charge the TX-78 itself.

To protect the TX-78 and keep its long lifetime, make sure the power of the TX-78 always is $\geq 75\%$ when using it to start a car.

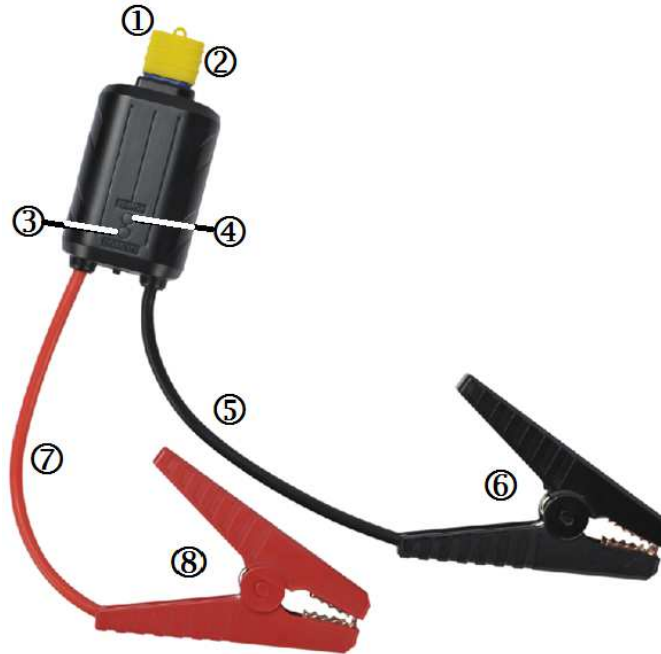

1	Moisture-proof cap (yellow)	5	Negative lead (black colour)
2	EC5-connector	6	Negative clamp (black colour)
3	Green/Red LED = "In Action"	7	Positive lead (red colour)
4	Blue LED = "Power"	8	Positive clamp (red colour)

The functions of the Jump Starter TX-78 device

● Testing the status of the battery of your car:

Do not connect the Jump-start cable with the TX-78. First connect the red and black clamps to the positive (+) and the negative (-) pole of the car battery.

→ "In Action" (3) and "Power" LEDs (4) are lighting for 5 seconds.

→ "In Action" LED displays the power level status as following: GREEN = Normal; RED + GREEN = Weak; RED flashing = Low.

● Warning Functions (the clamps are connected to the TX-78 and the car battery):

→ The red LED lights up and the buzzer give a Beep-Beep alarm when the (+) and (-) poles are connected inversely, or the TX-78 itself is defect.

→ It can happen, when the clamps are connected to the TX-78 and to the car battery correctly, the buzzer gives an alarm and the red LED lights up.

→→ This can mean, the voltage of the car battery is equal to the TX-78.

→→ This can mean, the power indicator of the TX-78 is ≤ 3 indicators. It indicates, the car battery power is too low to start the car.

→→ This can mean, although the power LED of the TX-78 shows "fully charged" (4–5 LEDs are BLUE), there may be another reason which causes that the car cannot be started.

● **Checking if the clamps, cable or LED-box have a malfunction or not (the clamps are either connected to the TX-78, or connected to the car battery):**

→ If there is a buzzing sound and the RED LED is on →→ the clamps, the cables or the LED-box may have a malfunction →→→ STOP USING.

→ If the EC5-connector is connected to the TX-78, but you do not use the device, first it will go for 4 minutes in standby mode and then it will turn OFF automatically.

How to start a car with the TX-78

→ Clamp the red clamp to the positive pole (+) of car battery (maximum contact area).

→→ Clamp the black clamp to the negative pole (-) of car battery (maximum contact area).

→→→ Connect the EC5 connector to the EC5 socket of the TX-78.

→→→→ After connecting, the BLUE "Power" LED (4) lights up (~4 minutes).

→→→→→ Shortly after, the GREEN "In Action" LED (3) lights up automatically, and you hear a "tick...tick" sound from buzzer. Now you can start the car.

→→→→→→ After starting the car, first remove the TX-78 from the clamps. The next step is first to remove the black clamp and the red clamp from the car battery.

How to start a car

⊕ Positive

⊖ Negative



1) Connect the clamps to the battery



2) Insert the plug into the jump starter



3) Start the car



4) Disconnect the jump starter



5) Remove the clamps

How to charge a digital device whose input is 5V

→ Choose the suitable data cable with USB connector.

→→ Put the USB connector into the 5V output of the Jump Starter.

→→→ Connect the other end of the data cable to the digital device, and then press the switch button, the indicator lights are on, and charging begins.

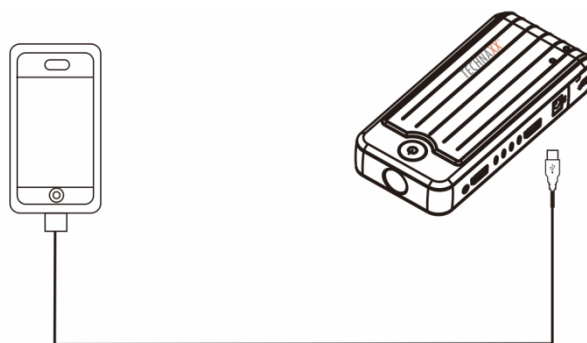

When you use 5V output to charge digital devices, the color of LED is RED.

Trouble shooting

No response when pressing the switch button on the Jump Starter TX-78 → Cause: maybe low voltage of the Jump Starter TX-78 → Solution: plug in the Jump Starter TX-78 to charge it.

Warnings

- Do not disassemble the device by yourself (voiding the warranty). Use the original home charger to recharge the device, or it may reduce the lifetime of the device.
- Make sure the blue plug of the cable into the socket of the device tightly, otherwise it cannot jump start the vehicle, and even make the joint melt.
- Do not start up car with the car jump starter when the power is less than 60% (3 BLUE LEDs or less are lighting) to avoid any damage. Take the product away after the car starts within 30 seconds. Otherwise may cause accidents. When finding the device expands, do not use it to start the car, to avoid safety accident. This product cannot be continuous to start the car, it may cause damage to the product.
- Each time you start the interval must be longer than 30 seconds. When starting the car continuously with 30 seconds pause, and it is not successful after 3 times, then stop starting to avoid causing damage to the device or safety accident.
- It will cause severe damage to the device when starting the car via this device continuously or use this device to start the car whose starting power is over this device, and it may cause safety accident easily.
- Do make sure the battery clamps well connected. If battery connector is rusted or dirty please clean it first, or the vehicle cannot be started. Do make sure the red clamp to the positive terminal, black clamp to the negative terminal, do not connect in the opposite way or it may damage the car. When the blue plug of the battery cable clamps is into the device, do not connect the two clamps, otherwise it will cause safety accident easily.
- Keep the device away from children. It should be only used by adults.

Indoor Storage Hints → Make sure it is out of the kids. ● Make sure it is far from fire and the object whose surface temperature is over 60°C, to avoid severe damage or burning. ● Make sure it is stored in no corrosive gas environment. ● Make sure it is stored in the environment between 15°C and 35°C, then the device will be originally good for 6 months.

Car Storage Hints → Remove the product and keep it indoors when the car interior temperature is not between -10°C up to 60°C to prevent serious damage or explosion. ● Make sure the device in the suitable position, to avoid damage caused by bumping.



Security and Disposal Hints for Batteries: Hold children off batteries. When a child swallowed a battery go to a doctors place or bring the child into a hospital promptly! Look for the right polarity (+) and (-) of batteries! Always change all batteries. Never use old and new batteries or batteries of different types together. Never short, open, deform or load up batteries! **Risk of injury!** Never throw batteries into fire! **Risk of explosion!**

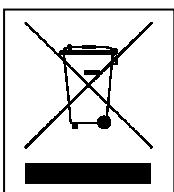

Hints for Environment Protection: Packages materials are raw materials and can be recycled. Do not disposal old devices or batteries into the domestic waste. **Cleaning:** Protect the device from contamination and pollution (use clean drapery). Avoid using rough, coarse-grained materials or solvents/aggressive cleaner. Wipe the cleaned device accurately. **Important Notice:** Should battery fluid leak from a battery, wipe the battery case with a soft cloth dry. **Distributor:** Technaxx Deutschland GmbH & Co.KG, Kruppstr. 105, 60388 Frankfurt a.M., Germany