

# Technaxx® \* User Manual

## TX-HR7 Fitnessstracker

### with body temperature measuring

The manufacturer Technaxx Deutschland GmbH & Co.KG hereby declares that this device, to which this user manual belongs, complies with the essential requirements of the standards referred to the Directive **RED 2014/53/EU**. The Declaration of Conformity you find here: **[www.technaxx.de/](http://www.technaxx.de/)** (in bar at the bottom "Konformitätserklärung"). Before using the device the first time, read the user manual carefully.

Service phone No. for technical support: 01805 012643 (14 cent/minute from German fixed-line and 42 cent/minute from mobile networks). Free  
Email: **[support@technaxx.de](mailto:support@technaxx.de)**

**This device has a rechargeable battery. It must be fully charged before first use. NOTE: Charge the battery of the device every 2–3 month if it is not used!**

Keep this user manual for future reference or product sharing carefully. Do the same with the original accessories for this product. In case of warranty, please contact the dealer or the store where you bought this product.

**Warranty 2 years**

***Enjoy your product \*Share your experience and opinion on one of the well-known internet portals.***

### Features

- Displays body temperature, heart rate, steps, distances, burned calories, sleep time, weather, date and time
- Fitnessstracker to monitor your sport activities, heart rate, your fitness and your sleep activities
- Notification reminder: calls, SMS, Email, WhatsApp, social media, achieved goals, activity reminder, drink reminder
- IP67 Waterproof
- 15 days standby time
- Wake up screen by turning your wrist

## Technical specifications

Display	0.96" Color Screen (80*160 Pixel)	
Processor	BK3431Q	
Heart rate sensor	HRS3300	
Temperature tolerance	$\pm 0.3^{\circ}\text{C}$	
Protection class	IP67	
Bluetooth / Distance	Bluetooth Version 4.0 / ~10m	
BT transmitting frequency	2.4GHz	
BT max. radiated output power	2.5mW	
Power supply	Built-in rechargeable 90mAh Lithium-ion battery 3,7V	
Operating time	~5 days usage / ~15 days standby	
Charging time	~1.5 hour	
APP	Youth health	
Weight / Dimensions	24g / (L) 40.5 x (W) 20 x (H) 12.5mm	
Storage temperature / Operation temperature	-10°C up to 45°C	
Package Contents	Technaxx® TX-HR7 Fitnesstracker, user manual	
Compatibility	Android 5.1 or above & iOS 10.0 or above	

## Charging

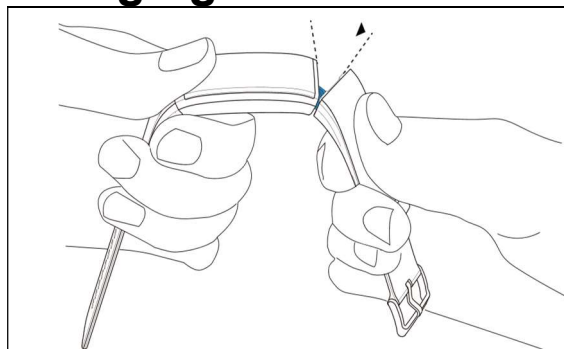

Pull off the strap closing side (USB) by holding the watch like shown in the picture besides

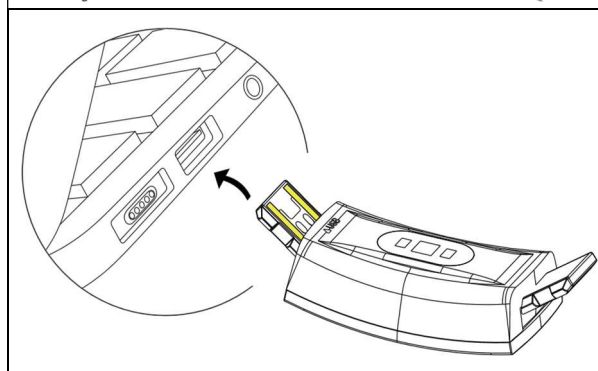

Now connect the fitnesstracker to a USB port to charge it

## Product overview

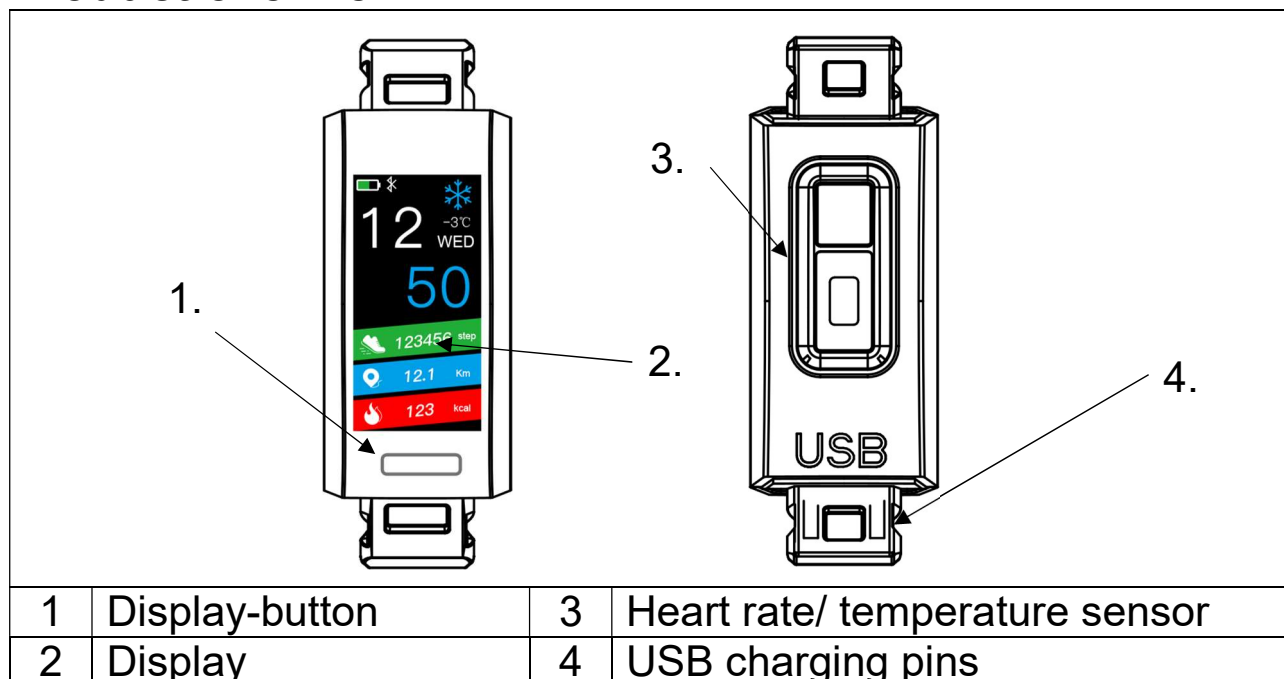

**NOTE:** The device should be charged at least 1 hour before use.

### Start up

Hold the display button for 5 seconds.

### Install “Youth health” APP on your Smartphone

Search for “Youth health” APP in the Google Play Store/Apple APP-Store or scan the following QR code for the installation.



**Note:** It is necessary to install the APP to use all functions of the watch

## Connect the Fitnesstracker with the Youth health APP

Wait until the device is fully charged. Activate the Bluetooth of your Smartphone. Open the Youth health APP. Confirm all requests to get the most out of the APP. Press „Add device“ under „Device“ and search for “TX-HR7”. Choose “TX-HR7” from the list and you are ready. Now the Fitnesstracker is connected with your Smartphone and the APP.

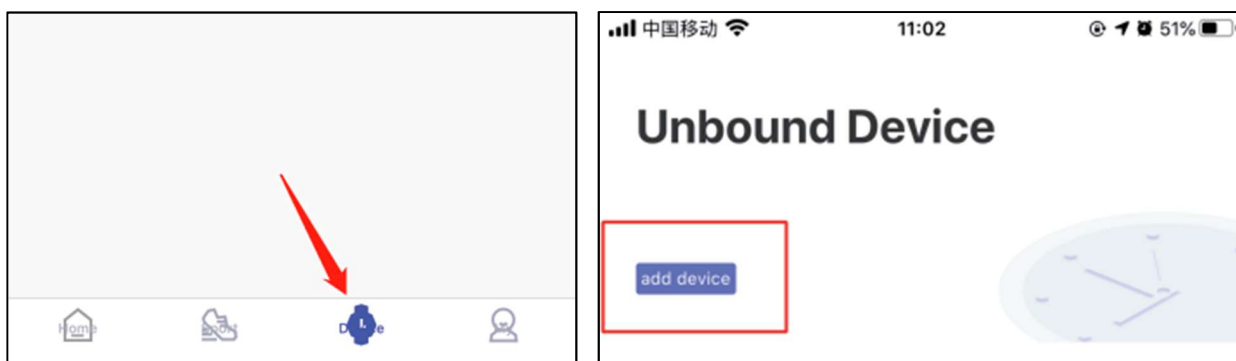

**INFO:** the Fitnesstracker will automatically reconnect with the mobile device if the last connected mobile device is turned on and the Bluetooth function is activated on both devices.

## Start using

When the Fitnesstracker is connected to the APP successfully, it will synchronize the time, the date and the language automatically. It counts steps, distance and calories. Press the display button to activate the LCD screen. Swipe with the display button through the menu. To start or enter an option hold the touch button.

## Main screen

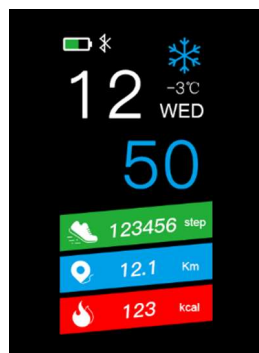

The main screen shows up common information like Date/Time/Weather. (Can be changed by holding down the display button)

## Step counter



24578

Press the display button until you see this information. The steps will be counted automatically. For more information about your steps please go to the APP.

## Distance



2.4 Km

Press the display button until you see this information. The distance will be calculated automatically. For more information about your covered distance please go to the APP.

## Calories counter



23 Kcal

Press the display button until you see this information. The burned calories will be calculated automatically. For more information about your burned calories please go to the APP.

## Health



Health

Press the display button until you see this option. Hold the button to go into this option. Here your temperature, your heart rate, blood pressure and blood oxygen can be measured.

## Sleep monitor

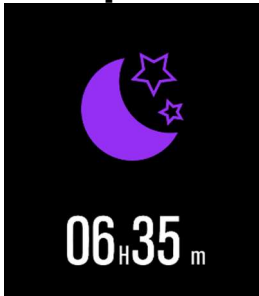

Press the display button until you see this information. The sleeping time will automatically measured from 21 to 9 o'clock. For more information about your sleep please go to the APP.

## Select a sport



Press the display button until you see this option. Hold the display button to enter this option. Now you can choose between different sports. Press until you have reached the desired sport. Now hold the button. The desired sport starts.

## Notifications

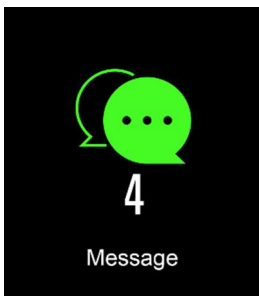

Press the display button until you see this information. Missed messages will be counted and displayed here.

## Settings

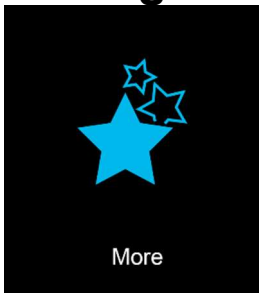

Press the display button until you see this option. Hold the button to enter this option. Here you see the system informations and reset are options. Power off the device also over this option.

## Power-Off

Press the display button until you see “More”. The last option under “More” is power off. Hold the button to power off the device.

## Hints

● Bluetooth connection becomes disconnected when the device exceeds a certain distance. ● Reconnect with Bluetooth if Bluetooth does not work for more than 5 min. ● Before binding the bracelet to another account, you need to unbind it with the current account. ● If the bracelet cannot be illuminated, connect the bracelet to a charger.

## Safety instructions

● Rebuilding or modifying the product impairs product safety. ● All modifications and repairs of the device or accessories must be performed by the manufacturer or by persons expressly authorized by the manufacturer. ● Never open the product by yourself or perform repairs by yourself! ● Handle the product carefully. It can be damaged by knocks, blows or even by falling from low height. ● Keep the product away from damp, moisture and extreme heat. ● Never immerse the product in water or other fluids. ● Technical specifications are subject to change without notice. ● Never heat the battery above 60°C and do not drop or throw it into the fire, danger of explosion/fire hazard! ● Do not short-circuit the battery. ● Do not subject the battery to mechanical stress. Avoid dropping, striking, bending, twisting or cutting the battery. ● Discontinue the charging process immediately should the battery become overheated. A battery that becomes overheated or deformed during the charging process is defective and should no longer be used. ● Never drain the battery completely, as this shortens its lifetime. ● If the battery must be stored, it is recommended that it be stored at 30% of its loading volume. Store out of direct sunlight. Ideal storage temperature: 10–20°C. ● Keep the product away from little children.

## Disposal

### Old electrical appliances from private households

● If you no longer want to use the appliance, hand it in free of charge at a public collection point for old electrical appliances. ● Old electrical appliances must never be placed in the residual waste bins.

### Further disposal instructions

● Return the old electrical appliance in such a way that its subsequent reuse or recycling is not impaired. Batteries must be removed beforehand and the destruction of containers containing liquids must be avoided. ● Old electrical appliances can contain harmful substances. If the device is handled incorrectly or damaged, this can lead to damage to health or water and soil contamination when the device is later recycled.

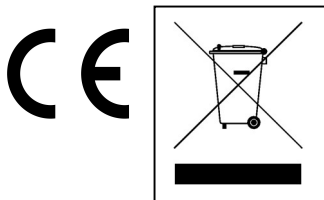

**Hints for Environment Protection:** Packages materials are raw materials and can be recycled. Do not disposal old devices or batteries into the domestic waste. **Cleaning:** Protect the device from contamination and pollution. Avoid using rough, coarse-grained materials or solvents/aggressive cleaner. Wipe the cleaned device accurately. **Distributor:** Technaxx Deutschland GmbH & Co.KG, Kruppstr. 105, 60388 Frankfurt a.M., Germany